

**SHAFFER, JOHNSTON, LICHTENWALTER  
& ASSOCIATES, INC.  
ENGINEERS & SURVEYORS**

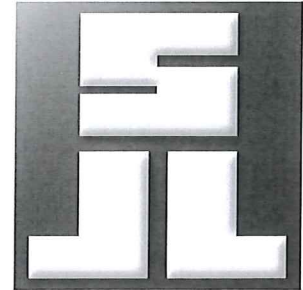

Boundary description of a 17.823 acre parcel SW 5780

Situated in the Township of Chester, T-20N; R-14W, Southeast Quarter of Section 27, County of Wayne, and State of Ohio:

Known as being lands conveyed to Daniel A. & Catherine P. Herms in O.R. 889; Page 853 of Wayne County Official Records and further bounded and described as follows:

Commencing at a record stone at the northwest corner of the Southeast Quarter of Section 27;

Thence N 89° 58' 59" E, 1140.82 feet along the quarter section line to a 1" pipe found at an angle point on lands conveyed to JD Redick Farm, LLC in O.R. 816; Page 1558 and O.R. 817; Page 1622 of Wayne County Official Records and the principal place of beginning of the parcel herein described:

THENCE WITH THE FOLLOWING TWENTY-TWO (22) COURSES:

- 1) continuing **N 89° 58' 59" E, 640.62** feet along the quarter section line to a point in Lattasburg Road ~ witnessed by a capped pin marked "GASBARRE" found N 50° 21' 05" W, 0.67 feet, also witnessed by a 5/8" rebar with I.D. cap marked "S.J.L., INC." set S 89° 58' 59" W, 90.00 feet;
- 2) **S 50° 21' 05" E, 104.43** feet in Lattasburg Road (S.R. 302) to a point at the northeast corner of lands conveyed to Vince D. & Sara L. Wakefield in O.R. 530; Page 936 of Wayne County Official Records ~ witnessed by a 3/4" pinch top found S 57° 42' 04" W, 45.08 feet;
- 3) **S 57° 42' 04" W, 171.12** feet along the north line of said Wakefield lands to a 5/8" rebar found at the northwest corner thereof;

Continued on Page 2

Page 2 (Description of 17.823 ac.)

- 4) **S 01° 42' 57" W, 260.48** feet along the west line of said Wakefield lands to a capped pin marked "S.J.L, INC." found at the southwest corner thereof;
- 5) **S 74° 13' 18" E, 107.73** feet along the south line of said Wakefield lands to a torsion bar found;
- 6) **N 67° 21' 25" E, 366.59** feet along a southeast line of said Wakefield lands to a point at the southeast corner thereof and in Lattasburg Road (S.R. 302) ~ witnessed by a 5/8" rebar with I.D. cap marked "S.J.L., INC." set S 67° 21' 25" W, 30.14 feet;
- 7) **S 50° 21' 05" E, 57.02** feet in Lattasburg Road (S.R. 302) to a point at the northeast corner of lands conveyed to Trinette Finley in O.R. 886; Page 4539 of Wayne County Official Records ~ witnessed by a 5/8" rebar with I.D. cap marked "S.J.L., INC." set S 67° 21' 03" W, 30.00 feet;
- 8) **S 67° 21' 03" W, 413.50** feet along the north line of said Finley lands to a 5/8" rebar with I.D. cap marked "S.J.L., INC." set at the northwest corner thereof;
- 9) **S 00° 39' 47" E, 48.52** feet along a west line of said Finley lands to a 3/4" pipe found at a northeast corner of lands conveyed to Jeffrey J. Myers in O.R. 162; Page 18 and O.R. 164; Page 310 of Wayne County Official Records;
- 10) **S 55° 45' 06" W, 21.10** feet along a north line of said Myers lands to a 3/4" pinch top found;
- 11) **S 21° 35' 56" W, 154.70** feet along a west line of said Myers lands to a 3/4" pinch top found at an angle point;
- 12) **S 74° 45' 56" W, 162.30** feet along a north line of said Myers lands to a 5/8" rebar with I.D. cap marked "S.J.L., INC." set;
- 13) **N 76° 04' 04" W, 98.30** feet along a northwest line of said Myers lands to a 5/8" rebar with I.D. cap marked "S.J.L., INC." set;
- 14) **S 41° 11' 56" W, 86.20** feet along a northeast line of said Myers lands to a 5/8" rebar with I.D. cap marked "S.J.L., INC." set;

Continued on Page 3

*3477 Commerce Parkway, Suite C □ Wooster, Ohio 44691  
Ph. (330) 345-6377 □ Fax (330) 345-6725 □ Email: sjl@sjl-inc.com*

Page 3 (Description of 17.823 ac.)

- 15) S 78° 35' 56" W, 98.30 feet along a north line of said Myers lands to a 5/8" rebar with I.D. cap marked "S.J.L., INC." set;
- 16) S 27° 15' 56" W, 177.40 feet along a west line of said Myers lands to an angle point ~ witnessed by a 5/8" rebar with I.D. cap marked "S.J.L., INC." set N 25° 32' 42" W, 3.50 feet;
- 17) N 25° 32' 42" W, 107.30 feet along an east line of said Myers lands to a 5/8" rebar with I.D. cap marked "S.J.L., INC." set;
- 18) N 57° 12' 48" W, 297.00 feet along a northeast line of said Myers lands to a 5/8" rebar with I.D. cap marked "S.J.L., INC." set;
- 19) S 89° 17' 18" W, 278.88 feet along a north line of said Myers lands to a 5/8" rebar with I.D. cap marked "S.J.L., INC." set at an angle point;
- 20) N 15° 03' 08" W, 591.36 feet along an east line of said Myers lands to a 5/8" rebar with I.D. cap marked "S.J.L., INC." set on a south line of aforesaid Redick lands;
- 21) S 74° 54' 20" E, 646.71 feet along a south line of said Redick lands to a 3/4" pipe found at a southeast corner thereof;
- 22) N 01° 35' 48" W, 310.49 feet along a west line of said Redick lands to the principal place of beginning and containing within said bounds 17.823 acres of land, more or less, and subject to all legal highways and easements of record.

This description was prepared from a survey made by Mark E. Purdy, P.S. #7307 of Shaffer, Johnston, Lichtenwalter & Associates, Inc. in December of 2018

Basis of bearing: The bearings as shown hereon are relative to GRID NORTH of the OHIO STATE PLANE COORDINATE SYSTEM, NAD 83 DATUM.

See Wayne County Survey Records Volume WW; Page 268 for survey.

OK MM 1/2/19

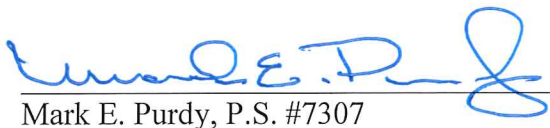
  
Mark E. Purdy, P.S. #7307

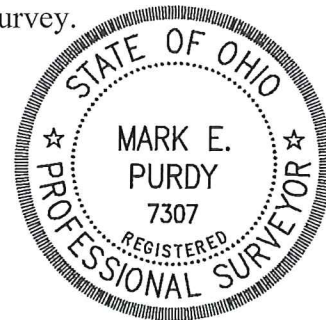

3477 Commerce Parkway, Suite C □ Wooster, Ohio 44691  
Ph. (330) 345-6377 □ Fax (330) 345-6725 □ Email: [sjl@sjl-inc.com](mailto:sjl@sjl-inc.com)