

Laurila Surveying

Professional Land Surveyors

H. David Laurila, P.S.

15333 Shore Rd., Sterling, OH 44276-9615

Phone 330-819-4415

www.laurilasurveying.com

Situated in the City of Wooster (T-16 north, R-13 west), County of Wayne and State of Ohio and being part of Lot 9620 of Plat Book 29, Page 523 the Howell Allotment #1 of the Wayne County Recorders Records and being bounded and described as follows:

BEGINNING at the 5/8" rebar with "S.J.L." cap found at the southwest corner of Lot 7076 of Plat Book 18, Page 519 of the Tori Circle Allotment;

1.) thence S 78°16'30" E, 81.66' along said Lot 7076 to a 5/8" rebar with "S.J.L." cap found;

2.) thence S 00°32'04" E, 30.70' along the easterly line of said Lot 9619 to a 5/8" rebar with a "Laurila 7663" cap found;

3.) thence S 78°16'30" E, 119.73' along the southerly line of said Lot 9619 to a 5/8" rebar with a "Laurila 7663" cap found;

4.) thence S 86°58'07" W, 117.19' to a point;

5.) thence N 45°57'01" W, 111.93' to the **TRUE POINT OF BEGINNING**.

The above described parcel contains 0.097 acres according to Wayne County Tax Map Office Survey Book XX, Page 27 as surveyed by H. David Laurila, P.S. 7663 of Laurila Surveying in March 25, 2021.

The basis of bearings are Grid North of the Ohio North Zone NAD 83, Cors96.

3-25-21

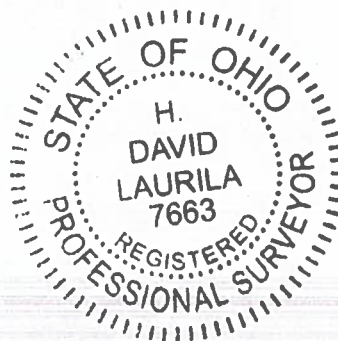

RECEIVED

JUL 30 2021

Property of Wayne County Tax Map Office

Laurila Surveying

Professional Land Surveyors

H. David Laurila, P.S.

15333 Shore Rd., Sterling, OH 44276-9615

Phone 330-819-4415

www.laurilasurveying.com

Situated in the City of Wooster (T-16 north, R-13 west), County of Wayne and State of Ohio and being part of Lot 9920 of Plat Book _____, Page _____ the Howell Allotment #2 of the Wayne County Recorders Records and being bounded and described as follows:

BEGINNING at the 5/8" rebar with "S.J.L." cap found at the southwest corner of Lot 9619 of Plat Book 18, Page 519 of the Tori Circle Allotment;

thence N 78°16'30" W, 21.91' along the southerly line of Lot 9619 to a point;

thence N 12°20'56" W, 30.69' along the existing pulic Sanitary Sewer Easement to a point;

thence S 25°02'01" W, 40.64' to a point;

thence N 86°58'07" E, 45.27' to a the **TRUE POINT OF BEGINNING**.

The above described Sanitary Sewer Easement contains 0.012 acres according to Wayne County Tax Map Office Survey Book XX, Page 27 as surveyed by H. David Laurila, P.S. 7663 of Laurila Surveying in June 25, 2021.

The basis of bearings are Grid North of the Ohio North Zone NAD 83, Cors96.