

Laurila Surveying

Professional Land Surveyors

H. David Laurila, P.S.
15333 Shore Rd., Sterling, OH 44276-9615
Phone 330-819-4415
www.laurilasurveying.com

Situated in the Township of Baughman, County of Wayne, State of Ohio and being part of the Southwest Quarter of Section 16, T-19 North, R-11 West of the Congress Lands and being bounded and described as follows:

Commencing at a Stone Found at the center of Section 16; thence S 00°33'39" E, 678.16' along the Quarter Section line to a 1" pipe found in Fosnight Road, TR 300; thence N 89°24'13" W, 215.85' to the **TRUE POINT OF BEGINNING**;

1.) thence S 00°33'39" E, 400.00' to a 5/8" rebar with a "Laurila 7663" cap set, passing through a 5/8" rebar with an orange "Laurila #7663" cap set at a distance of 25.00';

2.) thence N 89°24'13" W, 215.13' to a 5/8" rebar with a "Laurila 7663" cap set;

3.) thence N 00°32'31" W, 400.00' to a point, passing through a 5/8" rebar with an orange "Laurila #7663" cap set at a distance of 375.00';

4.) thence S 89°24'13" E, 215.00' to a the **TRUE POINT OF BEGINNING**.

The above described parcel contains 1.975 acres according to Wayne County Tax Map Office Survey Book XX, Page 159 as surveyed by H. David Laurila, P.S. 7663 of Laurila Surveying on February 2, 2022.

The Basis of Bearings is Grid North per ODOT VRS.

PP# _____

H. David Laurila 2-02-22

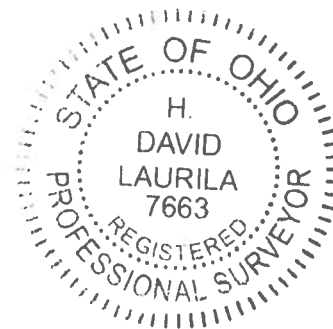

Laurila Surveying

Professional Land Surveyors

H. David Laurila, P.S.

15333 Shore Rd., Sterling, OH 44276-9615

Phone 330-819-4415

www.laurilasurveying.com

Situated in the Township of Baughman, County of Wayne, State of Ohio and being part of the Southwest Quarter of Section 16, T-19 North, R-11 West of the Congress Lands and being bounded and described as follows:

Commencing at a Stone Found at the center of Section 16; thence S 00°33'39" E, 678.16' along the Quarter Section line to a 1" pipe found in Fosnight Road, TR 300; thence N 89°24'13" W, 60.01' to the **TRUE POINT OF BEGINNING**;

- 1.) thence S 00°33'39" E, 400.00' to a 5/8" rebar with a "Laurila 7663" cap set, passing through a 5/8" rebar with an orange "Laurila #7663" cap set at a distance of 25.00';
- 2.) thence N 89°24'13" W, 155.84' to a 5/8" rebar with a "Laurila 7663" cap set;
- 3.) thence N 00°33'39" W, 400.00' to a point, passing through a 5/8" rebar with an orange "Laurila #7663" cap set at a distance of 375.00';
- 4.) thence S 89°24'13" E, 155.84' along the centerline of Fosnight Road to the **TRUE POINT OF BEGINNING**.

The above described parcel contains 1.431 acres according to Wayne County Tax Map Office Survey Book XX, Page 159 as surveyed by H. David Laurila, P.S. 7663 of Laurila Surveying on February 2, 2022.

The Basis of Bearings is Grid North per ODOT VRS.

PP# _____

 2-02-22

