

EWING LAND SURVEYING
GRAHAM EWING, P.S. 8769
1852 WILLIAMS WAY
WOOSTER, OHIO 44691
330-603-6144



May 25, 2024

10.0020 ACRES

Situated in the Township of Clinton (T-20-N R-15-W), County of Wayne, and the State of Ohio, and known as being part of North West and North East Quarters of Section 13 of said township, also known as being part of the land conveyed in ORV 746 PG 1748 and ORV 812 PG 2245 of the Wayne County Recorder's Records and being further bounded and described as follows:

COMMENCING at a 5/8" capped rebar found at the Center of Section 13 and being the **TRUE PLACE OF BEGINNING** of the herein described parcel;

1. Thence, Westerly with the South line of the North West Quarter of Section 13, **South 89° 52' 02" West**, a distance of **1032.54 feet** to a 5/8" rebar found;
2. Thence, leaving said Quarter line, North Easterly, **North 27° 10' 09" East**, a distance of **425.99 feet** to a capped 5/8" rebar set flush "EWING";
3. Thence, Easterly, **North 89° 52' 02" East**, a distance of **1076.13 feet** to a capped 5/8" rebar set flush "EWING";
4. Thence, South Easterly, **South 43° 05' 04" East**, a distance of **317.86 feet** to a capped 5/8" rebar found "RUDOLPH";
5. Thence, Westerly, **South 89° 17' 36" West**, a distance of **455.81 feet** to a capped 5/8" rebar found "RUDOLPH" on the East Quarter Line of Section 13;
6. Thence, Southerly with said Quarter Line, **South 00° 13' 18" East**, a distance of **141.31 feet** to the **TRUE PLACE OF BEGINNING**; and containing **10.0020 Acres** (435,687.5210 sq. ft.) of land, more or less, Subject to all easements and rights of ways public or private. Basis of Bearings for this survey is ODOT

VRS Ohio North State Plane Coordinate System NAD83.

Permanent Parcel Number PART OF 18.00061.008

For Survey See Volume XX, Page 826 of the Wayne County Survey Records;

Survey and description prepared by:

EWING LAND SURVEYING
GRAHAM R. EWING, P.S. 8769
1852 WILLIAMS WAY
WOOSTER, OHIO 44691
330-603-6144

Prior Deed Reference: ORV 746 Page 1748 and ORV 812 Page 2245



Graham R. Ewing

P.S. No. 8769

Date

5/28/24

EWING LAND SURVEYING
GRAHAM EWING, P.S. 8769
1852 WILLIAMS WAY
WOOSTER, OHIO 44691
330-603-6144



May 25, 2024

12.6451 ACRES

Situated in the Township of Clinton (T-20-N R-15-W), County of Wayne, and the State of Ohio, and known as being part of North West, North East, and the South East Quarters of Section 13 of said township, also known as being part of the land conveyed in ORV 746 PG 1748, ORV 812 PG 2245, ORV 257 PG 554, and ORV 586 PG 1770 of the Wayne County Recorder's Records and being further bounded and described as follows:

COMMENCING at a 5/8" capped rebar found at the Center of Section 13 and being the **TRUE PLACE OF BEGINNING** of the herein described parcel;

1. Thence, Westerly with the South line of the North West Quarter of Section 13, **South 89° 52' 02" West**, a distance of **1032.54 feet** to a 5/8" rebar found;
2. Thence, leaving said Quarter line, North Easterly, **North 27° 10' 09" East**, a distance of **425.99 feet** to a capped 5/8" rebar set flush "EWING";
3. Thence, Easterly, **North 89° 52' 02" East**, a distance of **1076.13 feet** to a capped 5/8" rebar set flush "EWING";
4. Thence, South Easterly, **South 43° 05' 04" East**, a distance of **317.86 feet** to a capped 5/8" rebar found "RUDOLPH";
5. Thence, Easterly, **North 89° 17' 36" East**, a distance of **44.52 feet** to a point on the center line of Columbus Road (S.R. 3) ;
6. Thence, South Westerly with a line in Columbus Road, **South 46° 54' 56" West**, a distance of **223.50 feet** to a point on the center line of Columbus Road and the South Line of the North East Quarter of Section 13;

7. Thence, continuing South Westerly with a line in Columbus Road, **South 46° 40' 59" West**, a distance of **457.49 feet** to a point on the center line of Columbus Road and the West Line of the South East Quarter of Section 13;

8. Thence, leaving said center line, Northerly with the West Line of said South East Quarter, **North 00° 39' 21" West**, passing over a 5/8" rebar found 4" high at a distance of 40.52 feet, a total distance of **319.06 feet** to the **TRUE PLACE OF BEGINNING**; and containing **12.6451 Acres** (550,818.5447 sq. ft.) of land, more or less, Subject to all easements and rights of ways public or private. Basis of Bearings for this survey is ODOT VRS Ohio North State Plane Coordinate System NAD83.

Permanent Parcel Number _____

For Survey See Volume XX, Page 826 of the Wayne County Survey Records;

Survey and description prepared by:

EWING LAND SURVEYING
GRAHAM R. EWING, P.S. 8769
1852 WILLIAMS WAY
WOOSTER, OHIO 44691
330-603-6144

Prior Deed Reference: ORV 746 Page 1748 and ORV 812 Page 2245
ORV 257 PG 554, and ORV 586 PG 1770

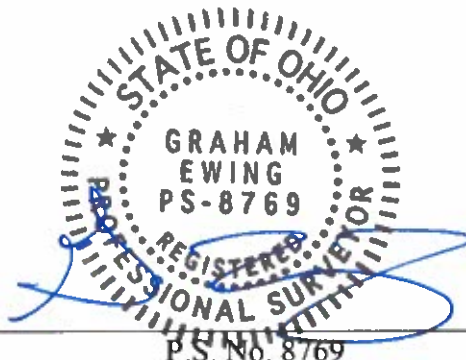

Graham R. Ewing

P.S. No. 8769

5/26/24

Date

EWING LAND SURVEYING

GRAHAM EWING, P.S. 8769
1852 WILLIAMS WAY
WOOSTER, OHIO 44691
330-603-6144

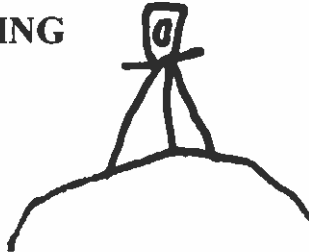

May 24, 2024

12.6451 ACRES

North: 373117.2690' East: 2074736.9080'

Segment #1 : Line

Course: S89°52'02.10"W Length: 1032.543'
North: 373114.8767' East: 2073704.3678'

Segment #2 : Line

Course: N27°10'09.45"E Length: 425.987'
North: 373493.8608' East: 2073898.8825'

Segment #3 : Line

Course: N89°52'02.10"E Length: 1076.132'
North: 373496.3541' East: 2074975.0116'

Segment #4 : Line

Course: S43°05'04.19"E Length: 317.862'
North: 373264.2045' East: 2075192.1355'

Segment #5 : Line

Course: N89°17'35.85"E Length: 44.518'
North: 373264.7536' East: 2075236.6501'

Segment #6 : Line

Course: S46°54'55.81"W Length: 223.503'
North: 373112.0840' East: 2075073.4154'

Segment #7 : Line

Course: S46°40'58.91"W Length: 457.490'
North: 372798.2304' East: 2074740.5595'

Segment #8 : Line

Course: N00°39'21.08"W Length: 319.060'
North: 373117.2695' East: 2074736.9074'

Perimeter: 3897.095' Area: 550818.54 Sq. Ft.
Error Closure: 0.0008 Course: N50°55'55.26"W
Error North: 0.00049 East: -0.00060

Precision 1: 4871368.750



EWING LAND SURVEYING

GRAHAM EWING, P.S. 8769
1852 WILLIAMS WAY
WOOSTER, OHIO 44691
330-603-6144



May 24, 2024

10.0020 ACRES

North: 373117.2690' East: 2074736.9080'

Segment #1 : Line

Course: S89°52'02.10"W Length: 1032.543'
North: 373114.8767' East: 2073704.3678'

Segment #2 : Line

Course: N27°10'09.45"E Length: 425.987'
North: 373493.8608' East: 2073898.8825'

Segment #3 : Line

Course: N89°52'02.10"E Length: 1076.132'
North: 373496.3541' East: 2074975.0116'

Segment #4 : Line

Course: S43°05'04.19"E Length: 317.862'
North: 373264.2045' East: 2075192.1355'

Segment #5 : Line

Course: S89°17'35.85"W Length: 455.810'
North: 373258.5825' East: 2074736.3602'

Segment #6 : Line

Course: S00°13'18.41"E Length: 141.314'
North: 373117.2696' East: 2074736.9072'

Perimeter: 3449.647' Area: 435687.52 Sq. Ft.
Error Closure: 0.0010 Course: N54°17'16.89"W
Error North: 0.00058 East: -0.00080

Precision 1: 3449648.000

