

Laurila Surveying

Professional Land Surveyors

H. David Laurila, P.S.
15333 Shore Rd., Sterling, OH 44276-9615
Phone 330-819-4415
www.laurilasurveying.com

Parcel 1

Situated in the Township of Chester, County of Wayne and State of Ohio and being located in the Northeast Quarter of Section 19, T-20 north, R-14 west, Congress Lands, south of the Connecticut Western Reserve and being bounded and described as follows:

Commencing at a 1" bar found in the Northeast corner of the Northeast Quarter and in Smithville Western Road, C.R. 86, a 60' right of way; thence S89°32'48"W, 885.91' along the Section line and C.R. 86 to a point; thence S2°20'02"E, 265.70' to the **TRUE POINT OF BEGINNING**;

1.) thence N 89°32'48" E, 276.90' to a 5/8" rebar with an orange "Laurila #7663" cap set;

2.) thence S 67°37'17" E, 326.34' to a 5/8" rebar with an orange "Laurila #7663" cap set;

3.) thence S 00°45'12" E, 32.10' to a 5/8" rebar with an orange "Laurila #7663" cap set;

4.) thence S 89°32'48" W, 506.01' to a 5/8" rebar with an orange "Laurila #7663" cap set;

5.) thence N 00°45'12" W, 98.61' to a 5/8" rebar with an orange "Laurila #7663" cap set;

6.) thence N 86°31'12" W, 58.32' to a 5/8" rebar with an orange "Laurila #7663" cap set;

7.) thence N 59°59'19" W, 13.66' to a nail set;

8.) thence N 02°02'02" W, 49.21' to the **TRUE POINT OF BEGINNING**.

The above described parcel contains 1.500 acres according to Wayne County Tax Map Office Survey Book XX, Page 920 as surveyed by H. David Laurila,

P.S. 7663 of Laurila Surveying on August 8, 2024.

Subject to a 30' access easement as described below.

Situated in the Township of Chester, County of Wayne and State of Ohio and being located in the Northeast Quarter of Section 19, T-20 north, R-14 west, Congress Lands, south of the Connecticut Western Reserve and being bounded and described as follows:

Commencing at a 1" bar found in the Northeast corner of the Northeast Quarter and in Smithville Western Road, C.R. 86, a 60' right of way; thence S89°32'48"W, 885.91' along the Section line and C.R. 86 to the **TRUE POINT OF BEGINNING**;

- 1.) thence S 02°02'02" E, 314.91' to a point;
- 2.) thence N 59°59'19" W, 35.39' to a point;
- 3.) thence N 02°02'02" W, 296.95' to a point;
- 4.) thence N 89°32'48" E, 30.01' to the **TRUE POINT OF BEGINNING**.

The above described assess easement contains 0.211 acres according to Wayne County Tax Map Office Survey Book XX, Page 920 as surveyed by H. David Laurila, P.S. 7663 of Laurila Surveying on August 8, 2024

The Basis of Bearings are Grid North per ODOT RTN.

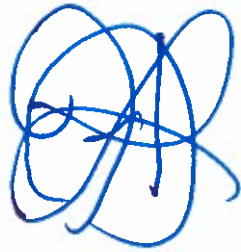

9-08-24

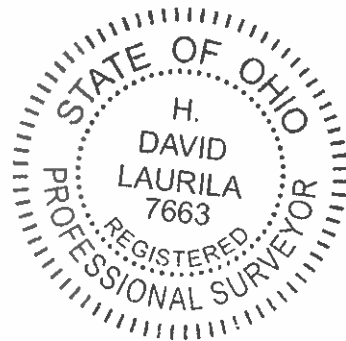

Laurila Surveying

Professional Land Surveyors

H. David Laurila, P.S.
15333 Shore Rd., Sterling, OH 44276-9615
Phone 330-819-4415
www.laurilasurveying.com

Parcel 2

Situated in the Township of Chester, County of Wayne and State of Ohio and being located in the Northeast Quarter of Section 19, T-20 north, R-14 west, Congress Lands, south of the Connecticut Western Reserve and being bounded and described as follows:

Commencing at a 1" bar found in the Northeast corner of the Northeast Quarter and in Smithville Western Road, C.R. 86, a 60' right of way; thence S89°32'48"W, 885.91' along the Section line and C.R. 86 to a point; thence S2°20'02"E, 314.91' to the **TRUE POINT OF BEGINNING**;

1.) thence S 59°59'19" E, 13.66' to a 5/8" rebar with an orange "Laurila #7663" cap set;

2.) thence S 86°31'12" E, 58.32' to a 5/8" rebar with an orange "Laurila #7663" cap set;

3.) thence S 00°45'12" E, 255.73' to a 5/8" rebar with an orange "Laurila #7663" cap set;

4.) thence S 89°32'48" W, 230.28' to a 5/8" rebar with an orange "Laurila #7663" cap set;

5.) thence N 00°45'12" W, 301.55' to a 5/8" rebar with an orange "Laurila #7663" cap set;

6.) thence S 89°40'53" E, 103.63' to a 5/8" rebar with an orange "Laurila #7663" cap set;

7.) thence S 59°59'19" E, 66.06' to the **TRUE POINT OF BEGINNING**.

The above described parcel contains 1.500 acres according to Wayne County Tax Map Office Survey Book XX, Page 920 as surveyed by H. David Laurila, P.S. 7663 of Laurila Surveying on August 8, 2024.

Subject to a 30' access easement as described below.

Situated in the Township of Chester, County of Wayne and State of Ohio and being located in the Northeast Quarter of Section 19, T-20 north, R-14 west, Congress Lands, south of the Connecticut Western Reserve and being bounded and described as follows:

Commencing at a 1" bar found in the Northeast corner of the Northeast Quarter and in Smithville Western Road, C.R. 86, a 60' right of way; thence S89°32'48"W, 885.91' along the Section line and C.R. 86 to the **TRUE POINT OF BEGINNING**;

- 1.) thence S 02°02'02" E, 314.91' to a point;
- 2.) thence N 59°59'19" W, 35.39' to a point;
- 3.) thence N 02°02'02" W, 296.95' to a point;
- 4.) thence N 89°32'48" E, 30.01' to the **TRUE POINT OF BEGINNING**.

The above described assess easement contains 0.211 acres according to Wayne County Tax Map Office Survey Book XX, Page 920 as surveyed by H. David Laurila, P.S. 7663 of Laurila Surveying on August 8, 2024.

The Basis of Bearings are Grid North per ODOT RTN.

 09-08-24

