

EWING LAND SURVEYING
GRAHAM EWING, P.S. 8769
1852 WILLIAMS WAY
WOOSTER, OHIO 44691
330-603-6144

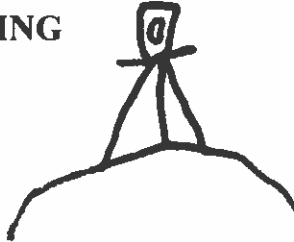

March 31, 2025

8.3918 ACRES

Situated in the Township of East Union (T-16-N R-12-W), County of Wayne, and the State of Ohio, and known as being part of North East Quarter of Section 12 of said township, also known as being part of the land conveyed in DV 479 PG 150 and DV 503 PG 65 of the Wayne County Recorder's Records and being further bounded and described as follows:

COMMENCING at a "V" found on the top of a stone found at the South East Corner of Section 12; Thence, Westerly with the South Line of North East Quarter of Section, **South 86° 04' 02" West**, a distance of **932.19 feet** to a capped 5/8" rebar set 3" high "EWING LAND SURVEYING PS-8769" on the South Line of a 21.58 Acre parcel conveyed in DV 479 PG 150, the West line of a sewer easement, and being the **TRUE PLACE OF BEGINNING** of the herein described parcel;

1. Thence, continuing Westerly with said Quarter Line and with said 21.58 Acre parcel, **South 86° 04' 02" West**, a distance of **423.61 feet** to a 12" x 18" stone with no marking found at the Southwest corner of said 21.58 Acre parcel and the Southeast corner of a 8.581 Acre parcel conveyed in DV 591 PG 732;

2. Thence, leaving said Quarter Line, Northerly, with a common line between said 21.58 Acre parcel and said 8.581 Acre parcel, **North 00° 45' 37" West**, passing by a 1/2" rebar found 2' high in a rock pile 0.92 feet west of line at a distance of 536.86 feet, a total distance of

834.95 feet to a capped 5/8" rebar set 3" high "EWING LAND SURVEYING PS-8769";

3. Thence, Easterly, with a common line between said 21.58 Acre parcel and said 8.581 Acre parcel, **North 88° 35' 36" East**, a distance of **47.70 feet** to a 1/2" pipe found rusted off on the South edge of a watercourse;

4. Thence, Northerly, with a common line between said 21.58 Acre parcel and said 8.581 Acre parcel, **North 14° 04' 22" East**, a distance of **52.56 feet** to a capped 5/8" rebar set 3" high "EWING LAND SURVEYING PS-8769" at the Southwest corner of a 2 Acre parcel conveyed in DV 177 PG 397;

5. Thence, Easterly, with a common line between said 21.58 Acre parcel and said 2 Acre parcel, **South 87° 57' 52" East**, a distance of **243.48 feet** to a capped 5/8" rebar set 3" high "EWING LAND SURVEYING PS-8769" at the Southeast corner of said 2 Acre parcel conveyed in DV 177 PG 397 and at the Southwest corner 4.28 Acre parcel conveyed in DV 503 PG 65 and on the North line of said 21.58 Acre parcel;

6. Thence, Northerly, with a common line between said 2 Acre parcel and said 4.28 Acre parcel, **North 02° 01' 12" East**, passing over a capped 5/8" rebar set flush "EWING LAND SURVEYING PS-8769" on the South Right of Way of New U.S. RT 30 at a distance of 306.89 feet, a total distance of **445.21 feet** to a point on the Old U.S. RT 30 centerline at a common corner of between said 2 Acre parcel and said 4.28 Acre parcel;

7. Thence, Easterly, with the centerline of Old U.S. RT 30, and the North line of said 4.28 Acre parcel, **South 88° 03' 44" East**, a distance of **60.71 feet** to a point at a common corner of said 4.28 Acre parcel and a 1.32 Acre parcel conveyed in DV 645 PG 1025;

8. Thence, Southerly, leaving the centerline of Old U.S. RT 30, and with a common line between said 4.28 Acre parcel and said 1.32 Acre parcel, **South 07° 43' 03" East**, passing over a 3/4" rebar found 8" deep at a distance of 137.27 feet, a total distance of **258.33 feet** to a capped 5/8" rebar set flush "EWING LAND SURVEYING PS-8769" at a common corner of said 4.28 Acre parcel and said 1.32 Acre parcel;

9. Thence, Southerly through said 4.28 Acre parcel, **South 11° 13' 42" West**, a distance of **193.20 feet** to a capped 5/8" rebar set flush "EWING LAND SURVEYING PS-8769" on the South line of said 4.28 Acre parcel and the North line of said 21.58 Acre parcel;

10. Thence, Southwesterly, though said 21.58 Acre parcel, **South 29° 50' 39" West**, a distance of **246.43 feet** to a capped 5/8" rebar set 3" high "EWING LAND SURVEYING PS-8769" on the West side of a 20 foot sewer easement ;

11. Thence, Southeasterly, though said 21.58 Acre parcel with the West side of a 20 foot sewer easement, **South 37° 42' 12" East**, a distance of **468.17 feet** to a capped 5/8" rebar set 3" high "EWING LAND SURVEYING PS-8769";

12. Thence, Southwesterly, though said 21.58 Acre parcel with the North side of a 20 foot sewer easement, **South 70° 10' 37" West**, a distance of **159.08 feet** to a capped 5/8" rebar set 3" high "EWING LAND SURVEYING PS-8769";

13. Thence, Southerly, though said 21.58 Acre parcel with the West side of a 20 foot sewer easement, **South 11° 29' 45" East**, a distance of **212.88 feet** to the **TRUE PLACE OF BEGINNING**; and containing **8.3918 Acres** (365,544.7624 sq. ft.) of land, more or less, Subject to all easements and rights of ways public or private. Basis of Bearings for this survey is ODOT VRS Ohio North State Plane Coordinate System NAD83.

Permanent Parcel Number _____

For Survey See Volume 44, Page 18 of the Wayne County
Survey Records;

Survey and description prepared by:

**EWING LAND SURVEYING
GRAHAM R. EWING, P.S. 8769
1852 WILLIAMS WAY
WOOSTER, OHIO 44691
330-603-6144**

Prior Deed References: DV 479 PG 150,DV 503 PG 65,DV 354 PG 85



Graham R. Ewing

P.S. No. 8769

Date

[Handwritten signature] 4/8/25

EWING LAND SURVEYING
GRAHAM EWING, P.S. 8769
1852 WILLIAMS WAY
WOOSTER, OHIO 44691
330-603-6144

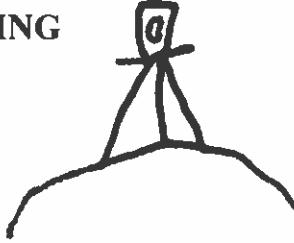

March 31, 2025

7.5199 ACRES FROM PPN: 26-00072.000

Situated in the Township of East Union (T-16-N R-12-W), County of Wayne, and the State of Ohio, and known as being part of North East Quarter of Section 12 of said township, also known as being part of the land conveyed in DV 479 PG 150 and DV 503 PG 65 of the Wayne County Recorder's Records and being further bounded and described as follows:

COMMENCING at a "V" found on the top of a stone found at the South East Corner of Section 12; Thence, Westerly with the South Line of North East Quarter of Section, **South 86° 04' 02" West**, a distance of **932.19 feet** to a capped 5/8" rebar set 3" high "EWING LAND SURVEYING PS-8769" on the South Line of a 21.58 Acre parcel conveyed in DV 479 PG 150, the West line of a sewer easement, and being the **TRUE PLACE OF BEGINNING** of the herein described parcel;

1. Thence, continuing Westerly with said Quarter Line and with said 21.58 Acre parcel, **South 86° 04' 02" West**, a distance of **423.61 feet** to a 12" x 18" stone with no marking found at the Southwest corner of said 21.58 Acre parcel and the Southeast corner of a 8.581 Acre parcel conveyed in DV 591 PG 732;

2. Thence, leaving said Quarter Line, Northerly, with a common line between said 21.58 Acre parcel and said 8.581 Acre parcel, **North 00° 45' 37" West**, passing by a 1/2" rebar found 2' high in a rock pile 0.92 feet west of line at a distance of 536.86 feet, a total distance of

834.95 feet to a capped 5/8" rebar set 3" high "EWING LAND SURVEYING PS-8769";

3. Thence, Easterly, with a common line between said 21.58 Acre parcel and said 8.581 Acre parcel, **North 88° 35' 36" East**, a distance of **47.70 feet** to a 1/2" pipe found rusted off on the South edge of a watercourse;

4. Thence, Northerly, with a common line between said 21.58 Acre parcel and said 8.581 Acre parcel, **North 14° 04' 22" East**, a distance of **52.56 feet** to a capped 5/8" rebar set 3" high "EWING LAND SURVEYING PS-8769" at the Southwest corner of a 2 Acre parcel conveyed in DV 177 PG 397;

5. Thence, Easterly, with a common line between said 21.58 Acre parcel and said 2 Acre parcel, **South 87° 57' 52" East**, a distance of **316.97 feet** to a capped 5/8" rebar set flush "EWING LAND SURVEYING PS-8769" on the South line of said 4.28 Acre parcel and the North line of said 21.58 Acre parcel;

6. Thence, Southwesterly, though said 21.58 Acre parcel, **South 29° 50' 39" West**, a distance of **246.43 feet** to a capped 5/8" rebar set 3" high "EWING LAND SURVEYING PS-8769" on the West side of a 20 foot sewer easement ;

7. Thence, Southeasterly, though said 21.58 Acre parcel with the West side of a 20 foot sewer easement, **South 37° 42' 12" East**, a distance of **468.17 feet** to a capped 5/8" rebar set 3" high "EWING LAND SURVEYING PS-8769";

8. Thence, Southwesterly, though said 21.58 Acre parcel with the North side of a 20 foot sewer easement, **South 70° 10' 37" West**, a distance of **159.08 feet** to a capped 5/8" rebar set 3" high "EWING LAND SURVEYING PS-8769";

9. Thence, Southerly, though said 21.58 Acre parcel with the West

side of a 20 foot sewer easement, **South 11° 29' 45" East**, a distance of **212.88 feet** to the **TRUE PLACE OF BEGINNING**; and containing **7.5199 Acres** (327,566.0598 sq. ft.) of land, more or less, Subject to all easements and rights of ways public or private. Basis of Bearings for this survey is ODOT VRS Ohio North State Plane Coordinate System NAD83.

Permanent Parcel Number _____

For Survey See Volume 44, Page 18 of the Wayne County Survey Records;

Survey and description prepared by:

EWING LAND SURVEYING
GRAHAM R. EWING, P.S. 8769
1852 WILLIAMS WAY
WOOSTER, OHIO 44691
330-603-6144

Prior Deed References: DV 479 PG 150,DV 503 PG 65,DV 354 PG 85



Graham R. Ewing

P.S. No. 8769

Date

[Handwritten signature] 4/8/25

EWING LAND SURVEYING
GRAHAM EWING, P.S. 8769
1852 WILLIAMS WAY
WOOSTER, OHIO 44691
330-603-6144



March 31, 2025

0.8719 ACRES FROM PPN: 26-00113.000

Situated in the Township of East Union (T-16-N R-12-W), County of Wayne, and the State of Ohio, and known as being part of North East Quarter of Section 12 of said township, also known as being part of the land conveyed in DV 645 PG 1025 and DV 503 PG 65 of the Wayne County Recorder's Records and being further bounded and described as follows:

COMMENCING at a "V" found on the top of a stone found at the South East Corner of Section 12; Thence, Westerly with the South Line of North East Quarter of Section, **South 86° 04' 02" West**, a distance of **220.91 feet** to a at the Southeast corner of a 21.58 Acre parcel conveyed in DV 479 PG 150; thence Northerly with a common line between said 21.58 Acre parcel and a 6.117 Acre parcel conveyed in DV 399 pg 462, **North 00° 39' 49" West**, a distance of **771.07 feet** to the Southeast corner of a 4.28 Acre parcel conveyed in DV 503 PG 65, Thence Westerly, with a common line between said 21.58 Acre parcel and said 4.28 Acre parcel, **North 87° 57' 52" West**, a distance of **757.62 feet** to a capped 5/8" rebar flush "EWING LAND SURVEYING PS-8769" and being the **TRUE PLACE OF BEGINNING** of the herein described parcel;

1. Thence, continuing Westerly with said common line, **North 87° 57' 52" West**, a distance of **73.49 feet** to a capped 5/8" rebar flush "EWING LAND SURVEYING PS-8769 ;

2. Thence, Northerly, with a common line between a 2 Acre parcel conveyed in DV 177 PG 697 and said 4.28 Acre parcel, **North 02° 01' 12" East**, passing over a capped 5/8" rebar set flush "EWING LAND SURVEYING PS-8769" on the South Right of Way of New U.S. RT 30 at a distance of 306.89 feet, a total distance of **445.21 feet** to a point on the Old U.S. RT 30 centerline at a common corner of between said 2 Acre parcel and said 4.28 Acre parcel;

3. Thence, Easterly, with the centerline of Old U.S. RT 30, and the North line of said 4.28 Acre parcel, **South 88° 03' 44" East**, a distance of **60.71 feet** to a point at a common corner of said 4.28 Acre parcel and a 1.32 Acre parcel conveyed in DV 645 PG 1025;

4. Thence, Southerly, leaving the centerline of Old U.S. RT 30, and with a common line between said 4.28 Acre parcel and said 1.32 Acre parcel, **South 07° 43' 03" East**, passing over a 3/4" rebar found 8" deep at a distance of 137.27 feet, a total distance of **258.33 feet** to a capped 5/8" rebar set flush "EWING LAND SURVEYING PS-8769" at a common corner of said 4.28 Acre parcel and said 1.32 Acre parcel;

5. Thence, Southerly through said 4.28 Acre parcel, **South 11° 13' 42" West**, a distance of **193.20 feet** to the **TRUE PLACE OF BEGINNING**; and containing **0.8719 Acres** (37,978.7026 sq. ft.) of land, more or less, Subject to all easements and rights of ways public or private. Basis of Bearings for this survey is ODOT VRS Ohio North State Plane Coordinate System NAD83.

Permanent Parcel Number _____

For Survey See Volume 44, Page 18 of the Wayne County Survey Records;

Survey and description prepared by:

**EWING LAND SURVEYING
GRAHAM R. EWING, P.S. 8769
1852 WILLIAMS WAY
WOOSTER, OHIO 44691
330-603-6144**

Prior Deed References: DV 503 PG 65, DV 645 PG 1025



Graham R. Ewing

P.S. No. 8769

Date

A handwritten signature in blue ink, appearing to be "G.R. Ewing", written over a horizontal line.

4/8/25

EWING LAND SURVEYING
GRAHAM EWING, P.S. 8769
1852 WILLIAMS WAY
WOOSTER, OHIO 44691
330-603-6144



March 31, 2025

4.1714 ACRES

Situated in the Township of East Union (T-16-N R-12-W), County of Wayne, and the State of Ohio, and known as being part of North East Quarter of Section 12 of said township, also known as being part of the land conveyed in DV 645 PG 1025 and DV 503 PG 65 of the Wayne County Recorder's Records and being further bounded and described as follows:

COMMENCING at a "V" found on the top of a stone found at the South East Corner of Section 12; Thence, Westerly with the South Line of North East Quarter of Section, **South 86° 04' 02" West**, a distance of **220.91 feet** to a at the Southeast corner of a 21.58 Acre parcel conveyed in DV 479 PG 150; thence Northerly with a common line between said 21.58 Acre parcel and a 6.117 Acre parcel conveyed in DV 399 pg 462, **North 00° 39' 49" West**, a distance of **771.07 feet** to the Southeast corner of a 4.28 Acre parcel conveyed in DV 503 PG 65, Thence Westerly, with a common line between said 21.58 Acre parcel and said 4.28 Acre parcel, **North 87° 57' 52" West**, a distance of **114.10 feet** to a capped 5/8" rebar flush "EWING LAND SURVEYING PS-8769" and being the **TRUE PLACE OF BEGINNING** of the herein described parcel;

1. Thence, continuing Westerly with said common line, **North 87° 57' 52" West**, a distance of **643.52 feet** to a capped 5/8" rebar flush "EWING LAND SURVEYING PS-8769 ;

2. Thence, leaving said common line, Northerly, through said 4.28

Acre parcel, **North 11° 13' 42" East**, a distance of **193.20 feet** to a capped 5/8" rebar flush "EWING LAND SURVEYING PS-8769 at the Southwest corner of a 1.32 Acre parcel conveyed in DV 645 PG 1025;

3. Thence, Northerly with common line between said 4.28 Acre parcel and said 1.32 Acre parcel, **North 07° 43' 03" West**, passing over a 3/4" rebar found 8" deep at a distance 121.12 feet on the South Right of Way of New U.S. RT 30, a total distance of **258.33 feet** a point on the Old U.S. RT 30 centerline at a common corner of between said 1.32 Acre parcel and said 4.28 Acre parcel;

4. Thence, Easterly, with the centerline of Old U.S. RT 30, and the North line of said 1.32 Acre parcel, **South 88° 03' 44" East**, a distance of **246.29 feet** to a point at a common corner of said 1.32 Acre parcel and a 2.19 Acre parcel conveyed in DV 305 PG 831;

5. Thence, Southerly, leaving the centerline of said Old U.S. RT 30, with a common line between said 1.32 Acre parcel and said 2.19 Acre parcel, **South 00° 43' 30" East**, passing over the base of a 1" bolt found 12" deep at a distance on 120.91 feet, a total distance of **245.00 feet** to the base of a 1/2" pipe found at a common corner of said 1.32 Acre parcels and said 2.19 Acre parcels and on the North line of said 4.28 Acre parcel;

6. Thence, Easterly, with a common line between said 4.28 Acre parcel and said 2.19 Acre parcel, **South 87° 58' 51" East**, a distance of **388.81 feet** to the base of a 1" pipe 4" high found at the Southeast corner of said 2.19 Acre parcels;

7. Thence, Southerly, through said 4.28 Acre parcel, **South 00° 40' 26" East**, a distance of **201.35 feet** to the **TRUE PLACE OF BEGINNING**; and containing **4.1714 Acres** (181,705.415 sq. ft.) of land, more or less, Subject to all easements and rights of ways public or private. Basis of Bearings for this survey is ODOT VRS Ohio North State Plane Coordinate System NAD83.

Permanent Parcel Number _____

For Survey See Volume 44, Page 18 of the Wayne County
Survey Records;

Survey and description prepared by:

**EWING LAND SURVEYING
GRAHAM R. EWING, P.S. 8769
1852 WILLIAMS WAY
WOOSTER, OHIO 44691
330-603-6144**

Prior Deed References: DV 503 PG 65, DV 645 PG 1025



Graham R. Ewing

P.S. No. 8769

Date

A large, stylized handwritten signature in blue ink, likely belonging to Graham R. Ewing, written over the signature line.

4/8/25

EWING LAND SURVEYING
GRAHAM EWING, P.S. 8769
1852 WILLIAMS WAY
WOOSTER, OHIO 44691
330-603-6144

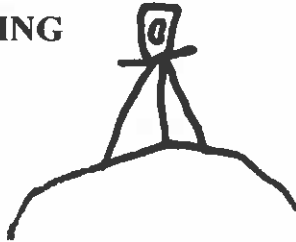

March 31, 2025

15.1923 ACRES

Situated in the Township of East Union (T-16-N R-12-W), County of Wayne, and the State of Ohio, and known as being part of North East Quarter of Section 12 of said township, also known as being part of the land conveyed in DV 479 PG 150, DV 503 pg65, and all of the land conveyed in DV 354 PG 985 of the Wayne County Recorder's Records and being further bounded and described as follows:

COMMENCING at a "V" found on the top of a stone found at the South East Corner of Section 12; Thence, Westerly with the South Line of North East Quarter of Section, **South 86° 04' 02" West**, a distance of **220.91 feet** to a point at the South East corner of the 21.58 Acre parcel conveyed in DV 479 PG 150, and being the **TRUE PLACE OF BEGINNING** of the herein described parcel;

1. Thence, continuing Westerly with said Quarter Line and with said 21.58 Acre parcel, **South 86° 04' 02" West**, a distance of **711.28 feet** to a capped 5/8" rebar set 3" high "EWING LAND SURVEYING PS-8769" to the West side of a 20 foot sewer easement;

2. Thence, leaving said Quarter Line, Northerly with the West side of a 20 foot sewer easement, though said 21.58 Acre parcel, **North 11° 29' 45" West**, a distance of **212.88 feet** to a capped 5/8" rebar set 3" high "EWING LAND SURVEYING PS-8769";

3. Thence, Northeasterly, though said 21.58 Acre parcel with the North side of a 20 foot sewer easement, **North 70° 10' 37" East**, a distance of **159.08 feet** to a capped 5/8" rebar set 3" high "EWING LAND SURVEYING PS-8769";

4. Thence, Northwesterly, though said 21.58 Acre parcel with the West side of a 20 foot sewer easement, **North 37° 42' 12" West**, a distance of **468.17 feet** to a capped 5/8" rebar set 3" high "EWING LAND SURVEYING PS-8769";

5. Thence, Northeasterly, though said 21.58 Acre parcel, **North 29° 50' 39" East**, a distance of **246.43 feet** to a capped 5/8" rebar set flush "EWING LAND SURVEYING PS-8769" on the North Line of said 21.58 Acre parcel and South Line of a 4.28 Acre parcel conveyed in DV 503 PG 65;

6. Thence, Easterly, with said 21.58 Acre parcel and 4.28 Acre parcel, **South 87° 57' 52" East**, a distance of **643.52 feet** to a capped 5/8" rebar set flush "EWING LAND SURVEYING PS-8769";

7. Thence, Northerly, though said 4.287 Acre parcel, and then with a common line between a 2.19 Acre parcel conveyed in DV 305 PG 831 and a 0.64 Acre parcel conveyed in DV 354 PG 985, **North 00° 40' 26" West**, passing over a 1" pipe found 4" high at the South West corner of said 0.64 Acre parcel and the South East corner of said 2.19 Acre parcel, also passing over a capped 5/8" rebar set flush "EWING LAND SURVEYING PS-8769" set on the South Right of Way of New U.S RT 30, at a distance of 334.27, a total distance of **446.90 feet** to a point on the Old U.S. RT 30 centerline at the North West corner of said 0.64 Acre parcel;

8. Thence, Easterly, with the centerline of Old U.S. RT 30, and the North line of said 0.64 Acre parcel,, **South 88° 03' 44" East**, a distance of **114.17 feet** to a point at the North East corner of said 0.64 Acre parcel;

9. Thence, Southerly, with a common line between said 0.64 Acre parcel, and then said 4.28 Acre parcel, and then said 21.58 Acre parcel and a 6.117 Acre parcel conveyed in DV 399 PG 462, **South 00° 39' 49" East**, passing over a capped 5/8" rebar set flush "EWING LAND SURVEYING PS-8769" set on the South Right of Way of New U.S RT 30 at a distance of 110.05 feet, a total distance of **1218.16 feet** to the **TRUE PLACE OF BEGINNING**; and containing **15.1923 Acres** (661,776.6010 sq. ft.) of land, more or less, Subject to all easements and rights of ways public or private. Basis of Bearings for this survey is ODOT VRS Ohio North State Plane Coordinate System NAD83.

Permanent Parcel Number _____

For Survey See Volume 44, Page 18 of the Wayne County Survey Records;

Survey and description prepared by:

**EWING LAND SURVEYING
GRAHAM R. EWING, P.S. 8769
1852 WILLIAMS WAY
WOOSTER, OHIO 44691
330-603-6144**

Prior Deed References: DV 479 PG 150,DV 503 PG 65,DV 354 PG 85

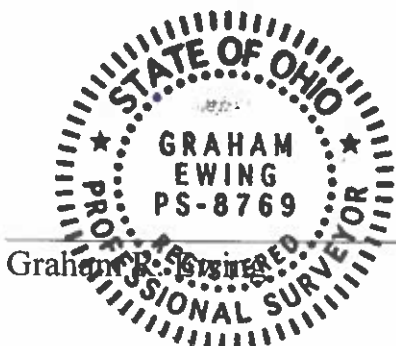

Graham R. Ewing

P.S. No. 8769

4/8/25

Date

EWING LAND SURVEYING
GRAHAM EWING, P.S. 8769
1852 WILLIAMS WAY
WOOSTER, OHIO 44691
330-603-6144



March 31, 2025

0.5252 ACRES FROM PPN: 26-00113.000

Situated in the Township of East Union (T-16-N R-12-W), County of Wayne, and the State of Ohio, and known as being part of North East Quarter of Section 12 of said township, also known as being part of the land conveyed in DV 645 PG 1025 and DV 503 PG 65 of the Wayne County Recorder's Records and being further bounded and described as follows:

COMMENCING at a "V" found on the top of a stone found at the South East Corner of Section 12; Thence, Westerly with the South Line of North East Quarter of Section, **South 86° 04' 02" West**, a distance of **220.91 feet** to a at the Southeast corner of a 21.58 Acre parcel conveyed in DV 479 PG 150; thence Northerly with a common line between said 21.58 Acre parcel and a 6.117 Acre parcel conveyed in DV 399 pg 462, **North 00° 39' 49" West**, a distance of **771.07 feet** to the Southeast corner of a 4.28 Acre parcel conveyed in DV 503 PG 65 and being the **TRUE PLACE OF BEGINNING** of the herein described parcel;

1. Thence, continuing Westerly with said common line, **North 87° 57' 52" West**, a distance of **114.10 feet** to a capped 5/8" rebar flush
"EWING LAND SURVEYING PS-8769 ;

2. Thence, Northerly, through said 4.28 Acre parcel, **North 00° 40' 26" West**, a distance of **201.35 feet** to 1" pipe found 4" high on the

North line of said 4.28 Acre parcel and at the Southeast corner of a 2.19 Acre parcel convey in DV 305 PG;

3. Thence, Easterly, with the North line of said 4.28 Acre parcel, **South 87° 58' 51" East**, a distance of **114.20 feet** to a point at a common corner of said 4.28 Acre parcel and a 0.64 Acre parcel conveyed in DV 354 PG 985 on the West line of said 6.117 Acre parcel;

4. Thence, Southerly, with a common line between said 4.28 Acre parcel and said 6.117 Acre parcel, **South 00° 39' 49" East**, a distance of **200.06 feet** to the **TRUE PLACE OF BEGINNING**; and containing **0.5252 Acres** (22,878.0245 sq. ft.) of land, more or less, Subject to all easements and rights of ways public or private. Basis of Bearings for this survey is ODOT VRS Ohio North State Plane Coordinate System NAD83.

Permanent Parcel Number _____

For Survey See Volume YY, Page 18 of the Wayne County Survey Records;

Survey and description prepared by:

EWING LAND SURVEYING
GRAHAM R. EWING, P.S. 8769
1852 WILLIAMS WAY
WOOSTER, OHIO 44691
330-603-6144



Prior Deed References: DV 503 PG 65, DV 645 PG 1025

Graham R. Ewing

P.S. No. 8769

Date

4/8/25

EWING LAND SURVEYING
GRAHAM EWING, P.S. 8769
1852 WILLIAMS WAY
WOOSTER, OHIO 44691
330-603-6144

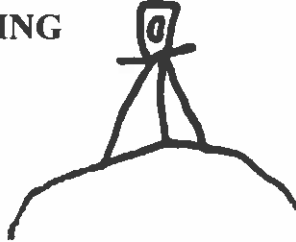

March 31, 2025

8.3918 ACRES

North: 411298.3041' East: 2170978.3089'

Segment #1 : Line

Course: S86° 04' 02"W Length: 423.608'

North: 411269.2505' East: 2170555.6984'

Segment #2 : Line

Course: N00° 45' 37"W Length: 834.950'

North: 412104.1270' East: 2170544.6195'

Segment #3 : Line

Course: N88° 35' 36"E Length: 47.700'

North: 412105.2979' East: 2170592.3051'

Segment #4 : Line

Course: N14° 04' 22"E Length: 52.557'

North: 412156.2776' East: 2170605.0845'

Segment #5 : Line

Course: S87° 57' 52"E Length: 243.480'

North: 412147.6292' East: 2170848.4109'

Segment #6 : Line

Course: N02° 01' 12"E Length: 445.209'

North: 412592.5616' East: 2170864.1038'

Segment #7 : Line
Course: S88° 03' 44"E Length: 60.710'
North: 412590.5087' East: 2170924.7791'

Segment #8 : Line
Course: S07° 43' 03"E Length: 258.330'
North: 412334.5186' East: 2170959.4699'

Segment #9 : Line
Course: S11° 13' 42"W Length: 193.198'
North: 412145.0186' East: 2170921.8505'

Segment #10 : Line
Course: S29° 50' 39"W Length: 246.432'
North: 411931.2679' East: 2170799.2154'

Segment #11 : Line
Course: S37° 42' 12"E Length: 468.171'
North: 411560.8567' East: 2171085.5362'

Segment #12 : Line
Course: S70° 10' 37"W Length: 159.082'
North: 411506.9093' East: 2170935.8807'

Segment #13 : Line
Course: S11° 29' 45"E Length: 212.876'
North: 411298.3038' East: 2170978.3062'

Perimeter: 3646.303' Area: 365544.76 Sq. Ft.
Error Closure: 0.0027 Course: S84° 15' 07"W
Error North: -0.00027 East: -0.00271

Precision 1: 1350482.593



EWING LAND SURVEYING
GRAHAM EWING, P.S. 8769
1852 WILLIAMS WAY
WOOSTER, OHIO 44691
330-603-6144

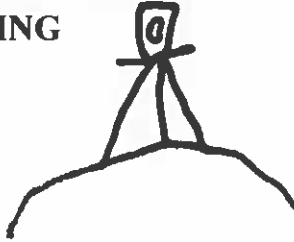

March 31, 2025

7.5199 ACRES FROM PPN: 26-00072.000

North: 411298.3041' East: 2170978.3089'

Segment #1 : Line

Course: S86° 04' 02"W Length: 423.608'

North: 411269.2505' East: 2170555.6984'

Segment #2 : Line

Course: N00° 45' 37"W Length: 834.950'

North: 412104.1270' East: 2170544.6195'

Segment #3 : Line

Course: N88° 35' 36"E Length: 47.700'

North: 412105.2979' East: 2170592.3051'

Segment #4 : Line

Course: N14° 04' 22"E Length: 52.557'

North: 412156.2776' East: 2170605.0845'

Segment #5 : Line

Course: S87° 57' 52"E Length: 243.480'

North: 412147.6292' East: 2170848.4109'

Segment #6 : Line

Course: S87° 57' 52"E Length: 73.487'

North: 412145.0190' East: 2170921.8515'

Segment #7 : Line
Course: S29° 50' 39"W Length: 246.432'
North: 411931.2683' East: 2170799.2164'

Segment #8 : Line
Course: S37° 42' 12"E Length: 468.171'
North: 411560.8570' East: 2171085.5372'

Segment #9 : Line
Course: S70° 10' 37"W Length: 159.082'
North: 411506.9097' East: 2170935.8817'

Segment #10 : Line
Course: S11° 29' 45"E Length: 212.876'
North: 411298.3042' East: 2170978.3072'

Perimeter: 2762.343' Area: 327566.06 Sq. Ft.
Error Closure: 0.0017 Course: N86° 13' 26"W
Error North: 0.00011 East: -0.00168

Precision 1: 1624907.647



EWING LAND SURVEYING
GRAHAM EWING, P.S. 8769
1852 WILLIAMS WAY
WOOSTER, OHIO 44691
330-603-6144

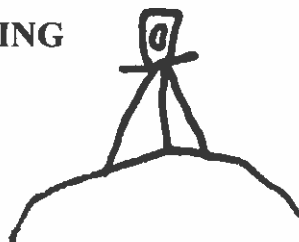

March 31, 2025

0.8719 ACRES FROM PPN: 26-00113.000

North: 412145.0189' East: 2170921.8523'

Segment #1 : Line

Course: N87° 57' 52"W Length: 73.487'

North: 412147.6291' East: 2170848.4116'

Segment #2 : Line

Course: N02° 01' 12"E Length: 445.209'

North: 412592.5614' East: 2170864.1045'

Segment #3 : Line

Course: S88° 03' 44"E Length: 60.710'

North: 412590.5086' East: 2170924.7798'

Segment #4 : Line

Course: S07° 43' 03"E Length: 258.330'

North: 412334.5185' East: 2170959.4707'

Segment #5 : Line

Course: S11° 13' 42"W Length: 193.198'

North: 412145.0185' East: 2170921.8512'

Perimeter: 1030.934' Area: 37978.70 Sq. Ft.

Error Closure: 0.0011 Course: S69° 30' 17"W

Error North: -0.00038 East: -0.00103

Precision 1: 937212.727



EWING LAND SURVEYING
GRAHAM EWING, P.S. 8769
1852 WILLIAMS WAY
WOOSTER, OHIO 44691
330-603-6144

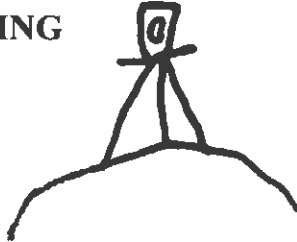

March 31, 2025

4.1714 ACRES

North: 412122.1610' East: 2171564.9630'

Segment #1 : Line

Course: N87°57'52"W Length: 643.517'

North: 412145.0185' East: 2170921.8521'

Segment #2 : Line

Course: N11°13'42"E Length: 193.198'

North: 412334.5185' East: 2170959.4715'

Segment #3 : Line

Course: N07°43'03"W Length: 258.330'

North: 412590.5086' East: 2170924.7806'

Segment #4 : Line

Course: S88°03'44"E Length: 246.290'

North: 412582.1805' East: 2171170.9298'

Segment #5 : Line

Course: S00°43'30"E Length: 245.000'

North: 412337.2002' East: 2171174.0298'

Segment #6 : Line

Course: S87°58'51"E Length: 388.806'

North: 412323.5010' East: 2171562.5944'

Segment #7 : Line

Course: S00°40'26"E Length: 201.354'

North: 412122.1610' East: 2171564.9626'

Perimeter: 2176.495' Area: 181705.42 Sq. Ft.

Error Closure: 0.0004 Course: S82°12'32"W

Error North: -0.00005 East: -0.00037

Precision 1: 5441237.500



EWING LAND SURVEYING
GRAHAM EWING, P.S. 8769
1852 WILLIAMS WAY
WOOSTER, OHIO 44691
330-603-6144

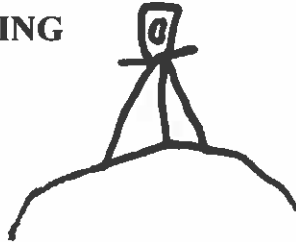

March 31, 2025

15.1923 ACRES

North: 411347.0881' East: 2171687.9148'

Segment #1 : Line

Course: S86° 04' 02"W Length: 711.281'

North: 411298.3041' East: 2170978.3087'

Segment #2 : Line

Course: N11° 29' 45"W Length: 212.876'

North: 411506.9097' East: 2170935.8832'

Segment #3 : Line

Course: N70° 10' 37"E Length: 159.082'

North: 411560.8570' East: 2171085.5387'

Segment #4 : Line

Course: N37° 42' 12"W Length: 468.171'

North: 411931.2683' East: 2170799.2179'

Segment #5 : Line

Course: N29° 50' 39"E Length: 246.432'

North: 412145.0190' East: 2170921.8530'

Segment #6 : Line

Course: S87° 57' 52"E Length: 643.517'

North: 412122.1614' East: 2171564.9639'

Segment #7 : Line

Course: N00° 40' 26"W Length: 446.897'

North: 412569.0275' East: 2171559.7078'

Segment #8 : Line

Course: S88° 03' 44"E Length: 114.167'

North: 412565.1671' East: 2171673.8096'

Segment #9 : Line

Course: S00° 39' 49"E Length: 1218.160'

North: 411347.0888' East: 2171687.9182'

Perimeter: 4220.582' Area: 661776.60 Sq. Ft.

Error Closure: 0.0035 Course: N78° 26' 42"E

Error North: 0.00071 East: 0.00346

Precision 1: 1205880.857



EWING LAND SURVEYING
GRAHAM EWING, P.S. 8769
1852 WILLIAMS WAY
WOOSTER, OHIO 44691
330-603-6144



March 31, 2025

0.5252 ACRES FROM PPN: 26-00113.000

North: 412118.1083' East: 2171678.9861'

Segment #1 : Line

Course: N87° 57' 52"W Length: 114.095'

North: 412122.1610' East: 2171564.9630'

Segment #2 : Line

Course: N00° 40' 26"W Length: 201.354'

North: 412323.5010' East: 2171562.5949'

Segment #3 : Line

Course: S87° 19' 07"E Length: 114.199'

North: 412318.1586' East: 2171676.6688'

Segment #4 : Line

Course: S00° 39' 49"E Length: 200.064'

North: 412118.1080' East: 2171678.9860'

Perimeter: 629.712' Area: 22878.02 Sq. Ft.

Error Closure: 0.0004 Course: S15° 15' 37"W

Error North: -0.00035 East: -0.00009

Precision 1: 1574280.000



