

Laurila Surveying

Professional Land Surveyors

H. David Laurila, P.S.
15333 Shore Rd., Sterling, OH 44276-9615
Phone 330-819-4415
www.laurilasurveying.com

Situated in the Township of Paint, County of Wayne and State of Ohio and being part of the Northwest Quarter of Section 7, T-15 north, R-11 west, Congress Lands and being bounded and described as follows:

Commencing at a 5/8" rebar found at the southeast corner of the said Northwest Quarter of Section 7; thence N 00°59'23" E, 548.37' along the said Quarter Section line and the centerline of Kohler Road, T.H. 129, a 33' right of way to a point at the northwest corner of a parcel now owned by Milan & Becky Coblentz as recorded in Official Record Volume 896, Page 4021 of the Wayne County Recorder's Records being the **TRUE POINT OF BEGINNING**, witnessed by a 5/8" rebar with "Baker" cap at S 89°20'30" W, 21.76';

- 1.) thence S 89°20'30" W , 238.39' along the northerly line of aforesaid Coblentz to a point, passing through a 5/8" rebar with an orange "Laurila #7663" cap set at a distance of 206.54';
- 2.) thence S 01°24'56" E , 33.27' along the westerly line of aforesaid Coblentz to a point;
- 3.) thence S 89°23'51" W , 299.01' to a 5/8" rebar with a "Laurila 7663" cap found, passing through a 5/8" rebar with an orange "Laurila #7663" cap set at a distance of 0.44';
- 4.) thence N 04°54'06" W , 461.07 along part of the easterly line of Norman R, & Kayla Coblentz as recorded in Official Record Volume 985, P. 5451 to a 5/8" rebar with a "Laurila 7663" cap set;
- 5.) thence N 86°53'03" E , 130.72' to a 5/8" rebar with a "Laurila 7663" cap set;
- 6.) thence N 00°04'43" E , 111.58' to a 5/8" rebar with a "Laurila 7663" cap set;
- 7) thence N 88°45'00" E , 435.90' to a point, passing through a 5/8" rebar with an orange "Laurila #7663" cap set at a distance of 410.29';
- 8.) thence S 00°59'23" E , 548.52' along said Kohler Road to the **TRUE POINT OF BEGINNING**.

The above described parcel contains 6.8632 acres according to Wayne County Tax Map Office Survey Book yy, Page 285 as surveyed by H. David Laurila, P.S. 7663 of Laurila Surveying on March 23, 2026.

The basis of bearings is GRID north per ODOT rtn.

 3-23-26

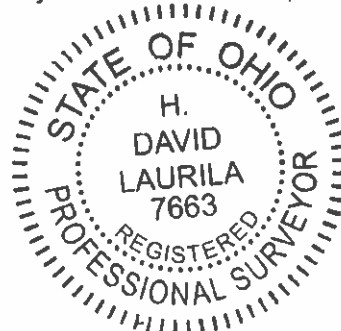

Laurila Surveying

Professional Land Surveyors

H. David Laurila, P.S.

15333 Shortle Rd., Sterling, OH 44276-9615

Phone 330-819-4415

www.laurilasurveying.com

Situated in the Township of Paint, County of Wayne and State of Ohio and being part of the Northwest Quarter of Section 7, T-15 north, R-11 west, Congress Lands and being bounded and described as follows:

Commencing at a 5/8" rebar found at the southeast corner of the said Northwest Quarter of Section 7; thence N 00°59'23" E, 822.49' along the said Quarter Section line and the centerline of Kohler Road, T.H. 129, a 33' right of way to the **TRUE POINT OF BEGINNING**;

- 1.) thence S 89°18'51" W , 558.14' along the northerly line of Matthew J. & Marneta M. Aka Marnetta M. Coblenz as recorded in Official Record Volume 906, P. 206 to a 5/8" rebar with a "Laurila 7663" cap found;
- 2.) thence N 04°54'06" W , 153.40' to a 5/8" rebar with a "Laurila 7663" cap set;
- 3.) thence N 86°53'03" E , 130.72' to a 5/8" rebar with a "Laurila 7663" cap set;
- 4.) thence N 00°04'43" E , 111.58' to a 5/8" rebar with a "Laurila 7663" cap set;
- 5.) thence N 88°45'00" E , 435.90' to a point, passing through a 5/8" rebar with an orange "Laurila #7663" cap set at a distance of 410.29';
- 6.) thence S 00°59'23" E , 274.40' along said Kolher Road to the **TRUE POINT OF BEGINNING**.

The above described parcel contains 3.1834 acres according to Wayne County Tax Map Office Survey Book YY, Page 285 as surveyed by H. David Laurila, P.S. 7663 of Laurila Surveying on March 23, 2026.

The basis of bearings is GRID north per ODOT rtn.

THIS 3.1834 ACRE PARCEL IS BEING CREATED AS AN EXEMPT PARCEL PURSUANT TO OHIO REVISED CODE SECTION 711.001 WHEREIN IT IS A TRANSFER OF PROPERTY BETWEEN ADJOINING LAND OWNERS AND DOES NOT CREATE AN ADDITIONAL BUILDING SITE AND IS NOT TO BE USED AS A SEPARATE BUILDING SITE OR TRANSFERRED AS AN INDEPENDENT PARCEL IN THE FUTURE.

 3-23-26



Lot Report

Wed, Apr 15 2026 12:31:47 PM

Lot File: D:\ls files\dwgs\WAY\paint\s7\nw\coblentz 26\coblentz26.lot
 CRD File: D:\ls files\dwgs\WAY\paint\s7\nw\coblentz 26\COBLETZ\coblentz26.crd

Lot: 2 , Block: 1, Type: Default

PNT#	Bearing	Distance	Northing	Easting	Station
3106			380076.9283	2174830.1581	0.00
	S 00°59'23" E	543.99			
3119			379533.0188	2174839.5539	543.99
	S 89°20'30" W	238.39			
3120			379530.2797	2174601.1774	782.38
	S 01°24'56" E	33.27			
3121			379497.0199	2174601.9993	815.65
	S 89°23'51" W	299.01			
3031			379493.8753	2174303.0058	1114.66
	N 04°54'06" W	307.67			
3033			379800.4172	2174276.7163	1422.33
	N 04°54'06" W	153.40			
3122			379953.2611	2174263.6081	1575.73
	N 86°53'03" E	130.72			
3115			379960.3666	2174394.1349	1706.45
	N 00°04'43" E	111.58			
3114			380071.9513	2174394.2877	1818.04
	N 88°45'00" E	435.90			
3123			380081.4611	2174830.0798	2253.94
	S 00°59'23" E	4.53			
3106			380076.9283	2174830.1581	2258.47

Closure Error Distance> 0.0000
 Total Distance> 2258.47
 Area: 6.8632 Acres

Lot: 3 , Block: 1, Type: Default

PNT#	Bearing	Distance	Northing	Easting	Station
3106			380076.9283	2174830.1581	0.00
	S 00°59'23" E	269.87			
3124			379807.0974	2174834.8193	269.87
	S 89°18'51" W	558.14			
3033			379800.4172	2174276.7163	828.01
	N 04°54'06" W	153.40			
3122			379953.2611	2174263.6081	981.42
	N 86°53'03" E	130.72			
3115			379960.3666	2174394.1349	1112.14
	N 00°04'43" E	111.58			
3114			380071.9513	2174394.2877	1223.72
	N 88°45'00" E	435.90			
3123			380081.4611	2174830.0798	1659.62
	S 00°59'23" E	4.53			
3106			380076.9283	2174830.1581	1664.15

Closure Error Distance> 0.0000
 Total Distance> 1664.15
 Area: 3.1834 Acres

Block 1 Total Area: 10.0465 Acres