



**DESCRIPTION OF A 1.787 ACRE PARCEL**

Situated in the Township of Sugar Creek, County of Wayne and the State of Ohio, being part of the Northeast Quarter of Section 30 (T-16N, R-11W) of the Congress Lands North of the Old Seven Ranges and being part of a parcel conveyed to Harvey H. Stutzman and Fannie Stutzman (PN: 47-01372.000) and recorded in O.R. Bk. 554, Page 621 of the Wayne County Official Records, and more fully bounded and described as follows:

**Beginning** at a bolt found at the northwest corner of said Northeast Quarter of Section 30; Thence N 89°05'55" E, along the north line of said Northeast Quarter of Section 30, and being the centerline of Hackett Road – C.R. 188, a distance of 692.99 feet to a point; Thence S 00°56'00" E, along the westerly line of a parcel conveyed to Reuben J. Hershberger and Martha A. Hershberger (PN: 47-01373.004) and recorded in O.R. Bk. 811, Page 62 of the Wayne County Official Records, passing over a 5/8" iron bar with an illegible cap found at 30.00 feet, a total distance of 425.64 feet to a 3/4" iron pin found, said point being the **True Place of Beginning** for the parcel of land herein described;

Course No. 1; Thence N 89°05'5" E, along the southerly line of said Reuben J. Hershberger and Martha A. Hershberger (PN: 47-01373.004) parcel, a distance of 263.53 feet to a point;

Course No. 2; Thence S 00°54'05" E, along a new line of division, a distance 299.52 feet to an iron pin set;

Course No. 3; Thence S 89°00'25" W, along a new line of division, a distance of 255.97 feet to an iron pin set;

Course No. 4; Thence N 02°20'47" W, along a new line of division, a distance of 300.02 feet to the **True Place of Beginning** and containing 1.787 acres of land, more or less, as surveyed by Joshua C. Lambert, P.S., Ohio Registration No. S-8666, for Castle Surveying, LLC, in February, 2026, but subject to all legal roads, highways, rights of way, easements and leases of record.

The Basis of Bearings is Ohio State Plane Coordinates, North Zone, NAD 1983 (2011).

All iron pins set are 30 inch X 5/8 inch rebar with plastic caps stamped "Castle Surveying".

Wayne County Survey Reference: 44-295

*Joshua C. Lambert* 3-10-26

Joshua C. Lambert, P.S. Professional Surveyor No. S-8666

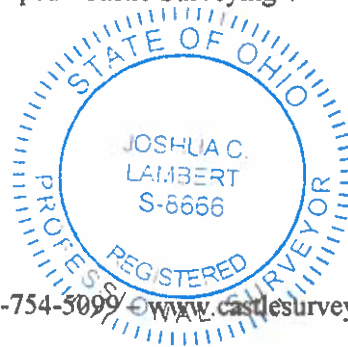

50 North Ave N.E., Office D, Massillon, OH 44646 – Phone: 330-754-5099 – [www.castlesurveying.com](http://www.castlesurveying.com)



**DESCRIPTION OF A 1.903 ACRE PARCEL**

Situated in the Township of Sugar Creek, County of Wayne and the State of Ohio, being part of the Northeast Quarter of Section 30 (T-16N, R-11W) of the Congress Lands North of the Old Seven Ranges and being part of a parcel conveyed to Harvey H. Stutzman and Fannie Stutzman (PN: 47-01372.000) and recorded in O.R. Bk. 554, Page 621 of the Wayne County Official Records, and more fully bounded and described as follows:

**Beginning** at a bolt found at the northwest corner of said Northeast Quarter of Section 30; Thence N 89°05'55" E, along the north line of said Northeast Quarter of Section 30, and being the centerline of Hackett Road – C.R. 188, a distance of 1233.78 to a mag nail set; Thence S 00°54'05" E, along the easterly line of a parcel conveyed to Joseph D. Miller and Susie A. Miller (PN: 47-01373.002) and recorded in O.R. Bk. 319, Page 786 of the Wayne County Official Records, crossing over an iron pin set at 30.00 feet, a total distance of 425.64 feet to a 5/8" iron bar found, said point being the **True Place of Beginning** for the parcel of land herein described;

Course No. 1; Thence S 00°54'05" E, along a new line of division, a distance of 299.07 feet to an iron pin set;

Course No. 2; Thence S 89°00'25" W, along a new line of division, a distance of 277.02 feet to an iron pin set;

Course No. 3; Thence N 00°54'05" W, along a new line of division, a distance of 299.52 feet to a point;

Course No. 4; Thence N 89°05'54" E, along the southerly line of said Joseph D. Miller and Susie A. Miller (PN: 47-01373.002) parcel, a distance of 277.02 feet to the **True Place of Beginning** and containing 1.903 acres of land, more or less, as surveyed by Joshua C. Lambert, P.S., Ohio Registration No. S-8666, for Castle Surveying, LLC, in February, 2026, but subject to all legal roads, highways, rights of way, easements and leases of record.

The Basis of Bearings is Ohio State Plane Coordinates, North Zone, NAD 1983 (2011).

All iron pins set are 30 inch X 5/8 inch rebar with plastic caps stamped "Castle Surveying".

Wayne County Survey Reference: YY-295

 310-26

Joshua C. Lambert, P.S. Professional Surveyor No. S-8666

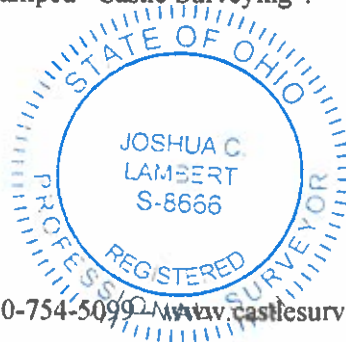

50 North Ave N.E., Office D, Massillon, OH 44646 – Phone: 330-754-5099 [www.castlesurveying.com](http://www.castlesurveying.com)



**DESCRIPTION OF A 3.069 ACRE PARCEL**

Situated in the Township of Sugar Creek, County of Wayne and the State of Ohio, being part of the Northeast Quarter of Section 30 (T-16N, R-11W) of the Congress Lands North of the Old Seven Ranges and being part of a parcel conveyed to Harvey H. Stutzman and Fannie Stutzman (PN: 47-01372.000) and recorded in O.R. Bk. 554, Page 621 of the Wayne County Official Records, and more fully bounded and described as follows:

**Beginning** at a bolt found at the northwest corner of said Northeast Quarter of Section 30; Thence N 89°05'55" E, along the north line of said Northeast Quarter of Section 30, and being the centerline of Hackett Road – C.R. 188, a distance of 1233.78 to a mag nail set; Thence S 00°54'05" E, along the westerly line of a parcel conveyed to Joe Miller and Susie Miller (PN: 47-01373.003) and recorded in Deed Volume 48, Page 54 of the Wayne County Official Records, crossing over an iron pin set at 30.00 feet, a total distance of 425.64 feet to a 5/8" iron bar found, said point being the **True Place of Beginning** for the parcel of land herein described;

Course No. 1; Thence N 89°05'54" E, along a southerly line of said Joe Miller and Susie Miller (PN: 47-01373.003) parcel, a distance of 413.55 feet to an iron pin set;

Course No. 2; Thence S 13°45'29" E, along a new line of division, a distance of 305.98 feet to an iron pin set;

Course No. 3; Thence S 89°00'25" W, along a new line of division, a distance of 481.63 feet to an iron pin set;

Course No. 4; Thence N 00°54'05" W, along a new line of division, a distance of 299.07 feet to the **True Place of Beginning** and containing 3.069 acres of land, more or less, as surveyed by Joshua C. Lambert, P.S., Ohio Registration No. S-8666, for Castle Surveying, LLC, in February, 2026, but subject to all legal roads, highways, rights of way, easements and leases of record.

The Basis of Bearings is Ohio State Plane Coordinates, North Zone, NAD 1983 (2011).

All iron pins set are 30 inch X 5/8 inch rebar with plastic caps stamped "Castle Surveying".

Wayne County Survey Reference: YY-295

 3-10-26

Joshua C. Lambert, P.S. Professional Surveyor No. S-8666



50 North Ave N.E., Office D, Massillon, OH 44646 – Phone: 330-754-5099 – [www.castlesurveying.com](http://www.castlesurveying.com)



### DESCRIPTION OF A 4.364 ACRE PARCEL

Situated in the Township of Sugar Creek, County of Wayne and the State of Ohio, being part of the Northeast Quarter of Section 30 (T-16N, R-11W) of the Congress Lands North of the Old Seven Ranges and being all of a parcel conveyed to Reuben J. Hershberger and Martha A. Hershberger (PN: 47-01373.004) and recorded in O.R. Bk. 811, Pg. 62 of the Wayne County Official Records, and being part of a parcel conveyed to Harvey H. Stutzman and Fannie Stutzman (PN: 47-01372.000) and recorded in O.R. Bk. 554, Page 621 of the Wayne County Official Records, and more fully bounded and described as follows:

**Beginning** at a bolt found at the northwest corner of said Northeast Quarter of Section 30; Thence N 89°05'55" E, along the north line of said Northeast Quarter of Section 30, also the centerline of Hackett Road – C.R. 188, a distance of 692.99 feet to a point, said point being the **True Place of Beginning** for the parcel of land herein described;

Course No. 1; Thence N 89°05'5" E, continuing along said north line of the Northeast Quarter of Section 30, also being said centerline of Hackett Road – C.R. 188, a distance of 263.77 feet to a point;

Course No. 2; Thence S 00°54'05" E, along the westerly line of a parcel conveyed to Joseph D. Miller and Susie A. Miller (PN: 47-01373.002) and recorded in O.R. Bk. 319, Page 786 of the Wayne County Official Records, and along a new line of division, crossing over an iron pin set at 30.00 feet, a total distance of 725.16 feet to an iron pin set;

Course No. 3; Thence S 89°00'25" W, along a new line of division, a distance of 255.97 feet to an iron pin set;

Course No. 4; Thence N 02°20'47" W, along a new line of division, a distance of 300.02 feet to a ¾" iron pin found;

Course No. 5; Thence N 00°56'00" W, along the westerly line of said Reuben J. Hershberger and Martha A. Hershberger (PN: 47-01373.004) parcel, crossing over an iron pin set at 395.64 feet, a total distance of 425.64 feet to the **True Place of Beginning** and containing 4.364 acres of land, of which 2.577 acres are from PN: 47-01373.004 and 1.787 acres are from PN: 47-01372.000, more or less, as surveyed by Joshua C. Lambert, P.S., Ohio Registration No. S-8666, for Castle Surveying, LLC, in February, 2026, but subject to all legal roads, highways, rights of way, easements and leases of record.

The Basis of Bearings is Ohio State Plane Coordinates, North Zone, NAD 1983 (2011).

All iron pins set are 30 inch X 5/8 inch rebar with plastic caps stamped "Castle Surveying".

Wayne County Survey Reference: YY-295



Joshua C. Lambert, P.S. Professional Surveyor No. S-8666

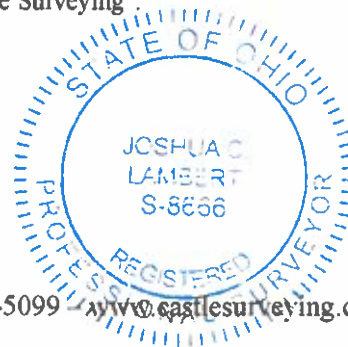

50 North Ave N.E., Office D, Massillon, OH 44646 – Phone: 330-754-5099 – [www.castlesurveying.com](http://www.castlesurveying.com)



**DESCRIPTION OF A 4.610 ACRE PARCEL**

Situated in the Township of Sugar Creek, County of Wayne and the State of Ohio, being part of the Northeast Quarter of Section 30 (T-16N, R-11W) of the Congress Lands North of the Old Seven Ranges and being all of a parcel conveyed to Joseph D. Miller and Susie A. Miller (PN: 47-01373.002) and recorded in O.R Bk. 319, Page 786 of the Wayne County Official Records, and being part of a parcel conveyed to Harvey H. Stutzman and Fannie Stutzman (PN: 47-01372.000) and recorded in O.R. Bk. 554, Page 621 of the Wayne County Official Records, and more fully bounded and described as follows:

**Beginning** at a bolt found at the northwest corner of said Northeast Quarter of Section 30; Thence N 89°05'55" E, along the north line of said Northeast Quarter of Section 30, also being the centerline of Hackett Road – C.R. 188, a distance of 956.76 feet to a point, said point being the **True Place of Beginning** for the parcel of land herein described;

Course No. 1; Thence N 89°05'55" E, along said north line of the Northeast Quarter of Section 30, and being said centerline of Hackett Road – C.R. 188, a distance of 277.02 feet to a point;

Course No. 2; Thence S 00°54'05" E, along a westerly line of a parcel conveyed to Joe Miller and Susie Miller (PN: 47-01373.003) and recorded in O.R Bk. 48, Page 54 of the Wayne County Official Records, and along a new line of division, a distance of 724.71 feet to an iron pin set;

Course No. 3; Thence S 89°00'25" W, along a new line of division, a distance of 277.02 feet to an iron pin set;

Course No. 4; Thence N 00°54'05" W, along a new line of division, and being an easterly line of a parcel conveyed to Reuben J. Hershberger and Martha A. Hershberger (PN: 47-01373.004) and recorded in O.R. Bk. 811, Page 62 of the Wayne County Official Records, crossing over an iron pin set at 695.16 feet, a total distance of 725.16 feet to the **True Place of Beginning** and containing 4.610 acres of land, of which 2.707 acres are from PN: 47-01373.002 and 1.903 acres are from PN: 47-01372.000, more or less, as surveyed by Joshua C. Lambert, P.S., Ohio Registration No. S-8666, for Castle Surveying, LLC, in February, 2026, but subject to all legal roads, highways, rights of way, easements and leases of record.

The Basis of Bearings is Ohio State Plane Coordinates, North Zone, NAD 1983 (2011).

All iron pins set are 30 inch X 5/8 inch rebar with plastic caps stamped "Castle Surveying".

Wayne County Survey Reference: YY-295

  
3-10-26

Joshua C. Lambert, P.S. Professional Surveyor No. S-8666

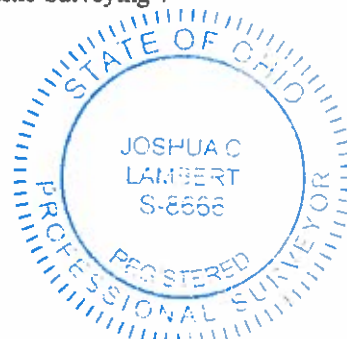

50 North Ave N.E., Office D, Massillon, OH 44646 – Phone: 330-754-5099 – [www.castlesurveying.com](http://www.castlesurveying.com)



### DESCRIPTION OF A 6.880 ACRE PARCEL

Situated in the Township of Sugar Creek, County of Wayne and the State of Ohio, being part of the Northeast Quarter of Section 30 (T-16N, R-11W) of the Congress Lands North of the Old Seven Ranges and being all of a parcel conveyed to Joe Miller and Susie Miller (PN: 47-01373.003) and recorded in Deed Volume 48, Page 54, and being part of a parcel conveyed to Harvey H. Stutzman and Fannie Stutzman (PN: 47-01372.000) and recorded in O.R. Bk. 554, Page 621, both of the Wayne County Official Records, and more fully bounded and described as follows:

**Beginning** at a bolt found at the northwest corner of said Northeast Quarter of Section 30; Thence N 89°05'55" E, along the north line of said Northeast Quarter of Section 30, also being the centerline of Hackett Road – C.R. 188, a distance of 1233.78 to a mag nail set, said point being the **True Place of Beginning** for the parcel of land herein described;

Course No. 1; Thence N 89°05'55" E, along said north line of the Northeast Quarter of Section 30, and being said centerline of Hackett Road – C.R. 188, a distance of 60.00 feet to mag nail set;

Course No. 2; Thence S 00°54'05" E, along the westerly line of a parcel conveyed to The Trustees of Apple Grove Amish Parochial School (PN: 47-01373.001) and recorded in O.R. Bk. 667, Page 439 of the Wayne County Official Records, crossing over an iron pin set at 30.00 feet, a total distance of 189.61 feet to an iron pin set;

Course No. 3; Thence N 89°05'55" E, along a southerly line of said Trustees of Apple Grove Amish Parochial School (PN: 47-01373.001) parcel, a distance of 290.94 feet to a 5/8" iron bar found;

Course No. 4; Thence S 13°45'29" E, along a westerly line of a parcel conveyed to Joseph D. Miller and Susie A. Miller (PN: 47-00833.000) and recorded in O.R. Bk. 960, Page 3873 of the Wayne County Official Records, a distance of 89.01 feet to an iron pin set;

Course No. 5; Thence N 89°09'20" E, along a southerly line of said parcel conveyed to Joseph D. Miller and Susie A. Miller (PN: 47-00833.000), along a southerly line of a parcel conveyed to Joseph D. Miller and Susie A. Miller (PN: 47-0834.000) and recorded in O.R. Bk. 960, Page 3873 of Wayne County Official Records, and along southerly lines of parcels conveyed to Glen B. Frantz and Barbara A. Frantz (PN: 47-01463.000 & 47-01462.000) and recorded in O.R. Bk.

50 North Ave N.E., Office D, Massillon, OH 44646 – Phone: 330-754-5099 – [www.castlesurveying.com](http://www.castlesurveying.com)

556, Page 584 of Wayne County Official Records, crossing over a 1" iron pipe found at 101.72 feet, a total distance of 455.83 feet to an iron pin set;

Course No. 6; Thence S 01°06'42" E, along a westerly line of a parcel conveyed to Christopher M. Hignight and Megan D. Hignight (PN: 47-00255.001) and recorded in O.R. Bk. 647, Page 435 of the Wayne County Official Records, a distance of 148.80 feet to a 5/8" 'Rudolph' capped iron pin found;

Course No. 7; Thence S 89°05'54" W, along a southerly line of said Joe Miller and Susie Miller (PN: 47-01373.003) parcel, a distance of 413.57 feet to an iron pin set;

Course No. 8; Thence S 13°45'29" E, along a new line of division, a distance of 305.98 feet to an iron pin set;

Course No. 9; Thence S 89°00'25" W, along a new line of division, a distance of 481.63 feet to an iron pin set;

Course No. 10; Thence N 00°54'05" W, along a new line of division, and along an easterly line of a parcel conveyed to Joseph D. Miller and Susie A. Miller (PN: 47-01373.002) and recorded in O.R Bk. 319, Page 786 of the Wayne County Official Records, crossing over an iron pin set at 694.71 feet, a total distance of 724.71 feet to the **True Place of Beginning** and containing 6.880 acres of land, of which 3.811 acres are from PN: 47-01373.003 and 3.069 acres are from PN: 47-01372.000, more or less, as surveyed by Joshua C. Lambert, P.S., Ohio Registration No. S-8666, for Castle Surveying, LLC, in February, 2026, but subject to all legal roads, highways, rights of way, easements and leases of record.

The Basis of Bearings is Ohio State Plane Coordinates, North Zone, NAD 1983 (2011).

All iron pins set are 30 inch X 5/8 inch rebar with plastic caps stamped "Castle Surveying".

Wayne County Survey Reference: 44-295

Joshua C. Lambert 3-10-26

Joshua C. Lambert, P.S. Professional Surveyor No. S-8666

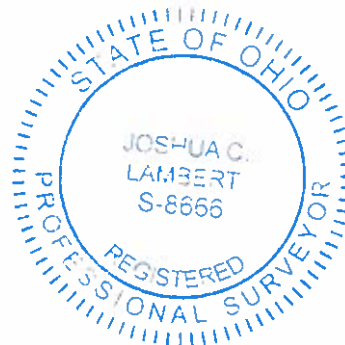

50 North Ave N.E., Office D, Massillon, OH 44646 – Phone: 330-754-5099 – [www.castlesurveying.com](http://www.castlesurveying.com)

C-26117 consolidation 3 DESCRIPTION

C-26117 Annex A

Inverse With Area

Mon, Mar 02 2026 11:44:15 AM

PntNo	Bearing	Distance	Northing	Easting	Description
PP			397260.95	2175634.76	
	N 89°05'54" E	263.53			
PP			397265.09	2175898.26	
	S 00°54'05" E	299.52			
2004			396965.61	2175902.98	
	S 89°00'25" W	255.97			
PP			396961.18	2175647.05	
	N 02°20'47" W	300.02			
PP			397260.95	2175634.76	
Closure Error Distance > 0.0000					
Total Distance Inversed > 1119.04					

Area: 77853 Sq. Feet, 1.787 Acres



*JCL*  
3-10-26

C-26117 Annex B

Inverse With Area

Mon, Mar 02 2026 11:44:49 AM

PntNo	Bearing	Distance	Northing	Easting	Description
PP			397269.45	2176175.25	
	S 00°54'05" E	299.07			
2023			396970.41	2176179.95	
	S 89°00'25" W	277.02			
2004			396965.61	2175902.98	
	N 00°54'05" W	299.52			
PP			397265.09	2175898.26	
	N 89°05'54" E	277.02			
PP			397269.45	2176175.25	

Closure Error Distance > 0.0000

Total Distance Inversed > 1152.63

Area: 82911 Sq. Feet, 1.903 Acres

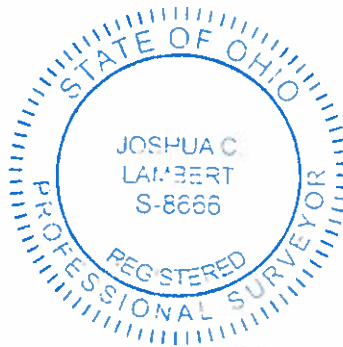

*JCL*  
3-10-26

C-26117 Annex C

Inverse With Area

Mon, Mar 02 2026 11:45:14 AM

PntNo	Bearing	Distance	Northing	Easting	Description
PP			397269.45	2176175.25	
	N 89°05'54" E	413.55			
2006			397275.96	2176588.74	
	S 13°45'29" E	305.98			
2005			396978.76	2176661.51	
	S 89°00'25" W	481.63			
2023			396970.41	2176179.95	
	N 00°54'05" W	299.07			
PP			397269.45	2176175.25	
Closure Error Distance > 0.0000					
Total Distance Inversed > 1500.23					

Area: 133703 Sq. Feet, 3.069 Acres

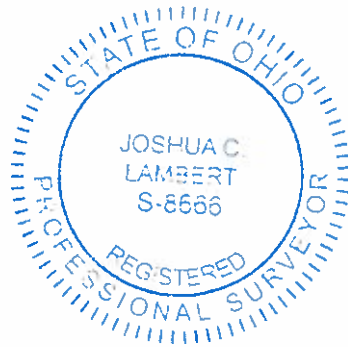

*JCL*  
3-10-26

C-26117 Consolidation A

Inverse With Area

Mon, Mar 02 2026 11:42:11 AM

PntNo	Bearing	Distance	Northing	Easting	Description
2016			397686.53	2175627.83	
	N 89°05'55" E	263.77			
2014			397690.68	2175891.57	
	S 00°54'05" E	725.16			
2004			396965.61	2175902.98	
	S 89°00'25" W	255.97			
PP			396961.18	2175647.05	
	N 02°20'47" W	300.02			
PP			397260.95	2175634.76	
	N 00°56'00" W	425.64			
2016			397686.53	2175627.83	

Closure Error Distance > 0.0000

Total Distance Inversed > 1970.56

Area: 190074 Sq. Feet, 4.364 Acres

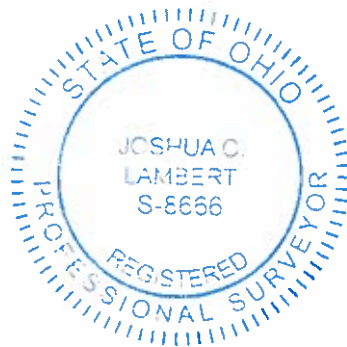

*JCL*  
3-10-26

C-26117 Consolidation B

Inverse With Area

Mon, Mar 02 2026 11:42:58 AM

PntNo	Bearing	Distance	Northing	Easting	Description
2014			397690.68	2175891.57	
	N 89°05'55" E	277.02			
2012			397695.04	2176168.55	
	S 00°54'05" E	724.71			
2023			396970.41	2176179.95	
	S 89°00'25" W	277.02			
2004			396965.61	2175902.98	
	N 00°54'05" W	725.16			
2014			397690.68	2175891.57	

Closure Error Distance > 0.0000 Error Bearing > N 90°00'00" E  
Closure Precision > 1 in 4270132195104.5 Total Distance Inversed > 2003.91

Area: 200821 Sq. Feet, 4.610 Acres

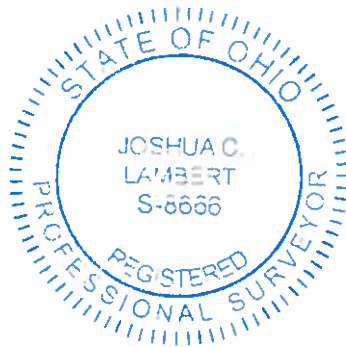

*JCL*

3-10-26

C-26117 Consolidation C

Inverse With Area

Mon, Mar 02 2026 11:43:37 AM

PntNo	Bearing	Distance	Northing	Easting	Description
2012			397695.04	2176168.55	
	N 89°05'55" E	60.00			
2011			397695.98	2176228.55	
	S 00°54'05" E	189.61			
2009			397506.40	2176231.53	
	N 89°05'55" E	290.94			
16			397510.97	2176522.43	
	S 13°45'29" E	89.01			
2008			397424.52	2176543.60	
	N 89°09'20" E	455.83			
2007			397431.24	2176999.38	
	S 01°06'42" E	148.80			
PP			397282.46	2177002.26	
	S 89°05'54" W	413.57			
2006			397275.96	2176588.74	
	S 13°45'29" E	305.98			
2005			396978.76	2176661.51	
	S 89°00'25" W	481.63			
2023			396970.41	2176179.95	
	N 00°54'05" W	724.71			
2012			397695.04	2176168.55	

Closure Error Distance > 0.0000

Total Distance Inversed > 3160.07

Area: 299698 Sq. Feet, 6.880 Acres

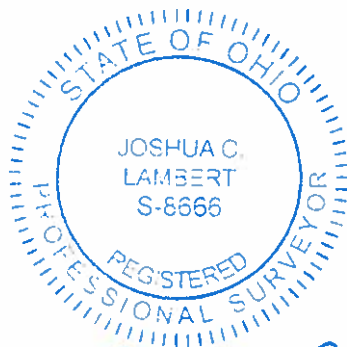

*JCL*  
3-10-26