

Laurila Surveying

Professional Land Surveyors

H. David Laurila, P.S.
15333 Shortle Rd., Sterling, OH 44276-9615
Phone 330-819-4415
www.laurilasurveying.com

Situated in the Township of Milton, County of Wayne and State of Ohio and being part of the Northwest Quarter of Section 4, T-18 north, R-12 west, Congress Lands south of the Connecticut Western Reserve and being bounded and described as follows:

Commencing at the Southeast Quarter of Section 4 and along the centerline of Doylestown Road, CH 70, a 60' right of way, N 89°27'00" W, 150.04' to the **TRUE POINT OF BEGINNING**;

1.) thence **N 89°27'00" W, 240.68'** continuing along said Doylestown Road to a point;

2.) thence **N 00°47'45" W, 724.16'** along the westerly line of a parcel conveyed to Carl & Coletta Cradock as recorded in Official Record Volume 518, P. 852 of the Wayne County Recorders Office to a 5/8" rebar with an orange "Laurila #7663" cap set, passing through a 5/8" rebar with an orange "Laurila #7663" cap set at a distance of 30.01';

3.) thence **S 89°27'00" E, 240.68'** to a 5/8" rebar with an orange "Laurila #7663" cap set;

4.) thence **S 00°47'45" E, 724.16'** to a the **TRUE POINT OF BEGINNING**, passing through a 5/8" rebar with an orange "Laurila #7663" cap set at a distance of 694.16'.

The above described parcel contains **4.000 acres** according to Wayne County Tax Map Office Survey Book XX, Page 424 as surveyed by H. David Laurila, P.S. 7663 of Laurila Surveying on December 18, 2022.

The basis of bearings is an assumed direction to be used for angular determination only.

 3-01-2023

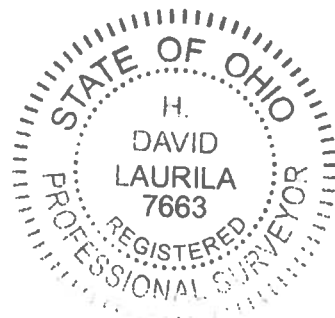

Laurila Surveying

Professional Land Surveyors

H. David Laurila, P.S.

15333 Shore Rd., Sterling, OH 44276-9615

Phone 330-819-4415

www.laurilasurveying.com

Situated in the Township of Milton, County of Wayne and State of Ohio and being part of the Northwest Quarter of Section 4, T-18 north, R-12 west, Congress Lands south of the Connecticut Western Reserve and being bounded and described as follows:

BEGINNING at 1" pipe found at the Southeast corner of the Northwest Quarter of Section 4 and along the centerline of Doylestown Road, CH 70, a 60' right of way;

1.) thence **N 89°27'00" W, 150.04'** continuing along the centerline of said Doylestown Road to a point;

2.) thence **N 00°47'45" W, 724.16'** to a 5/8" rebar with an orange "Laurila #7663" cap set, passing through a 5/8" rebar with an orange "Laurila #7663" cap set at a distance of 30.01';

3.) thence **N 89°27'00" W, 240.68'** to a 5/8" rebar with an orange "Laurila #7663" cap set;

4.) thence **N 00°47'45" W, 406.74'** along the westerly line of a parcel conveyed to Carl & Coletta Cradock as recorded in Official Record Volume 518, P. 852 of the Wayne County Records Office to a 5/8" rebar found, shot at spin;

5.) thence **S 89°26'29" E, 390.72'** along the southerly line of a parcel conveyed to Carol Ann McCoy, aka Carol A. McCoy as recorded in Official Record Volume 607, P. 114 and Deed Vol 586, P. 1431 of the Wayne County Records Office to a 5/8" rebar with an orange "Laurila #7663" cap found;

6.) thence **S 00°47'45" E, 1130.84'** along the easterly line of Kenneth L. Bauman, Trustee and Joshua A. Bauman as recorded in Official Record Volume 745, P. 181 to the **TRUE POINT OF BEGINNING**, passing through a 5/8" rebar with an orange "Laurila #7663" cap set at a distance of 1100.83'.

The above described parcel contains **6.141 acres** according to Wayne County Tax Map Office Survey Book XX, Page 424 as surveyed by H. David Laurila, P.S. 7663 of Laurila Surveying on December 18, 2022.

The basis of bearings is an assumed direction to be used for angular determination only.

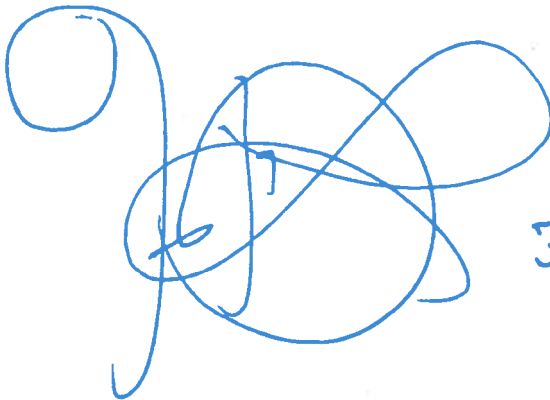
A handwritten signature in blue ink, consisting of a large, stylized 'H' followed by a series of loops and a final flourish.

301-2023

