

DESIGN FILE: \\projects\84605\row\sheet\WAY-302-6.22\84605R0001-6.22.dgn
WORKSTATION: neilsson DATE: 6/4/2014 MODELNAME: Design

PROJECT CONTROL
OHIO STATE PLANE GRID MAD 83 (GORS 98)
NORTH ZONE DATUM
PROJECT ADJUSTMENT FACTOR = 3.2813016
METRIC GRID TO ENGLISH PROJECT
COORDINATE MULTIPLIER

MONUMENT LEGEND
● EXISTING R/W MONUMENT BOX
■ PROPOSED R/W MONUMENT BOX
● EXISTING CONCRETE MONUMENT
● PROPOSED CONCRETE MONUMENT
● RAILROAD SPRUE FOUND
○ RAILROAD SPRUE SET
○ IRON PIN FOUND W/ ID CAP
○ IRON PIN FOUND W/ ID CAP
○ IRON PIPE FOUND
○ IRON PIPE SET
○ P. X. MAIL FOUND
○ P. X. MAIL SET

NOTE: THE EXISTING CENTERLINE OF RIGHT OF WAY, RIGHT OF WAY LINES, AND RIGHT OF WAY WIDTHS WERE DETERMINED FROM EXISTING RIGHT OF WAY MONUMENTATION AND FROM THE FOLLOWING O.D.O.T. PLANS:
WAY-302-1.29 (1989)
WAY-302-1.3 (M13, M13.813, M13.78) (1990)
WAY-302-2.3 (M13, M13.813, M13.78) (1990)
SH 641 SEC. C.D. & E-PT (1932)
DEDICATION PLAT OF SAVANNAH-WOOSTER RD (1936)
SEE COORDINATE TABLE CENTERLINE PLAT SHEETS 6 & 7.

PROJECT CONTROL
I, RAYMOND W. FOOS, P.S., HAVE CONDUCTED A SURVEY OF THE EXISTING CONDITIONS FOR THE OHIO DEPARTMENT OF TRANSPORTATION. THE RESULTS OF THAT SURVEY ARE CONTAINED HEREIN.

UNDERGROUND UTILITY LOCATIONS ARE SHOWN FOR INFORMATIONAL PURPOSES ONLY. THOUGH THEY ARE BELIEVED TO BE ACCURATE, THEIR LOCATION IS AS MARKED ON THE GROUND BY THE UTILITY COMPANY PER OUPS CONFIGURATION NUMBER AIRTR27, AIRTR08, & AIRTR03, OCPPS CONFIGURATION NUMBER 88377 AND THOSE MARKINGS SUBSEQUENTLY BEING SURVEYED AS A PART OF THIS PROJECT.

THE HORIZONTAL COORDINATES EXPRESSED HEREIN ARE BASED ON THE OHIO STATE PLANE COORDINATE SYSTEM, NORTH ZONE BY TIES TO THE ODOT VRS NETWORK. POSITIONAL TOLERANCES OF ALL CONTROL POINTS MEET THE CURRENT ODOT SURVEY AND MAPPING SPECIFICATIONS. THE UNLESS PROJECT ADJUSTMENT FACTOR USED FOR THIS PROJECT IS 1.00009047.

FURTHERMORE, I HAVE CALCULATED THE PROPOSED PROPERTY LINES, GROSS TAKE, PRESENT ROAD OCCUPIED, NET TAKE AND RESIDUE MEASUREMENTS AND THE VERTICALLY ADJUSTED DATA, AS WELL AS PREPARED THE LEGAL DESCRIPTIONS NECESSARY TO ACQUIRE THESE PARCELS AS SHOWN HEREIN.

AS PART OF THIS PROJECT I HAVE DETERMINED THE LOCATIONS OF THE EXISTING PROPERTY LINES FOR PROPERTY TAKES POINTS SHOWN HEREIN, AS CONDUCTED IN ACCORDANCE WITH OHIO ADMINISTRATIVE CODE 4733-37 COMMONLY KNOWN AS MINIMUM STANDARDS FOR BOUNDARY SURVEY IN THE STATE OF OHIO UNLESS SO NOTED.

THE MONUMENTS I AND MY AS USED HEREIN ARE TO MEAN THAT EITHER MYSELF OR SOMEONE WORKING FOR ME UNDER MY DIRECT CONTROL AND SUPERVISION.

RAYMOND W. FOOS, PROFESSIONAL LAND SURVEYOR NO. 7812

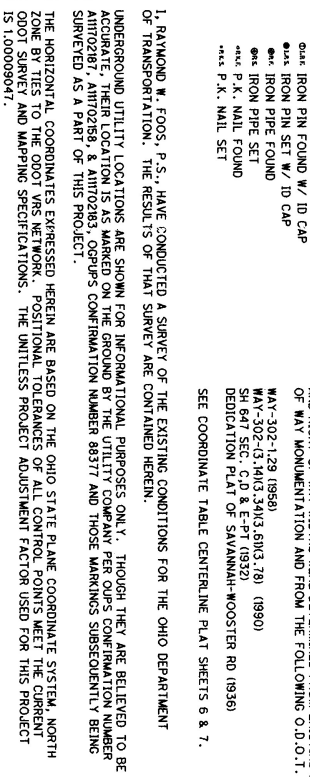

MONUMENT LEGEND
● EXISTING R/W MONUMENT BOX
■ PROPOSED R/W MONUMENT BOX
● EXISTING CONCRETE MONUMENT
● PROPOSED CONCRETE MONUMENT
● RAILROAD SPRUE FOUND
○ RAILROAD SPRUE SET
○ IRON PIN FOUND W/ ID CAP
○ IRON PIN FOUND W/ ID CAP
○ IRON PIPE FOUND
○ IRON PIPE SET
○ P. X. MAIL FOUND
○ P. X. MAIL SET

NOTE: THE EXISTING CENTERLINE OF RIGHT OF WAY, RIGHT OF WAY LINES, AND RIGHT OF WAY WIDTHS WERE DETERMINED FROM EXISTING RIGHT OF WAY MONUMENTATION AND FROM THE FOLLOWING O.D.O.T. PLANS:
WAY-302-1.29 (1989)
WAY-302-1.3 (M13, M13.813, M13.78) (1990)
WAY-302-2.3 (M13, M13.813, M13.78) (1990)
SH 641 SEC. C.D. & E-PT (1932)
DEDICATION PLAT OF SAVANNAH-WOOSTER RD (1936)
SEE COORDINATE TABLE CENTERLINE PLAT SHEETS 6 & 7.

PROJECT CONTROL
I, RAYMOND W. FOOS, P.S., HAVE CONDUCTED A SURVEY OF THE EXISTING CONDITIONS FOR THE OHIO DEPARTMENT OF TRANSPORTATION. THE RESULTS OF THAT SURVEY ARE CONTAINED HEREIN.

UNDERGROUND UTILITY LOCATIONS ARE SHOWN FOR INFORMATIONAL PURPOSES ONLY. THOUGH THEY ARE BELIEVED TO BE ACCURATE, THEIR LOCATION IS AS MARKED ON THE GROUND BY THE UTILITY COMPANY PER OUPS CONFIGURATION NUMBER AIRTR27, AIRTR08, & AIRTR03, OCPPS CONFIGURATION NUMBER 88377 AND THOSE MARKINGS SUBSEQUENTLY BEING SURVEYED AS A PART OF THIS PROJECT.

THE HORIZONTAL COORDINATES EXPRESSED HEREIN ARE BASED ON THE OHIO STATE PLANE COORDINATE SYSTEM, NORTH ZONE BY TIES TO THE ODOT VRS NETWORK. POSITIONAL TOLERANCES OF ALL CONTROL POINTS MEET THE CURRENT ODOT SURVEY AND MAPPING SPECIFICATIONS. THE UNLESS PROJECT ADJUSTMENT FACTOR USED FOR THIS PROJECT IS 1.00009047.

FURTHERMORE, I HAVE CALCULATED THE PROPOSED PROPERTY LINES, GROSS TAKE, PRESENT ROAD OCCUPIED, NET TAKE AND RESIDUE MEASUREMENTS AND THE VERTICALLY ADJUSTED DATA, AS WELL AS PREPARED THE LEGAL DESCRIPTIONS NECESSARY TO ACQUIRE THESE PARCELS AS SHOWN HEREIN.

AS PART OF THIS PROJECT I HAVE DETERMINED THE LOCATIONS OF THE EXISTING PROPERTY LINES FOR PROPERTY TAKES POINTS SHOWN HEREIN, AS CONDUCTED IN ACCORDANCE WITH OHIO ADMINISTRATIVE CODE 4733-37 COMMONLY KNOWN AS MINIMUM STANDARDS FOR BOUNDARY SURVEY IN THE STATE OF OHIO UNLESS SO NOTED.

THE MONUMENTS I AND MY AS USED HEREIN ARE TO MEAN THAT EITHER MYSELF OR SOMEONE WORKING FOR ME UNDER MY DIRECT CONTROL AND SUPERVISION.

RAYMOND W. FOOS, PROFESSIONAL LAND SURVEYOR NO. 7812

PROJECT CONTROL
OHIO STATE PLANE GRID MAD 83 (GORS 98)
NORTH ZONE DATUM
PROJECT ADJUSTMENT FACTOR = 3.2813016
METRIC GRID TO ENGLISH PROJECT
COORDINATE MULTIPLIER

MONUMENT LEGEND
● EXISTING R/W MONUMENT BOX
■ PROPOSED R/W MONUMENT BOX
● EXISTING CONCRETE MONUMENT
● PROPOSED CONCRETE MONUMENT
● RAILROAD SPRUE FOUND
○ RAILROAD SPRUE SET
○ IRON PIN FOUND W/ ID CAP
○ IRON PIN FOUND W/ ID CAP
○ IRON PIPE FOUND
○ IRON PIPE SET
○ P. X. MAIL FOUND
○ P. X. MAIL SET

NOTE: THE EXISTING CENTERLINE OF RIGHT OF WAY, RIGHT OF WAY LINES, AND RIGHT OF WAY WIDTHS WERE DETERMINED FROM EXISTING RIGHT OF WAY MONUMENTATION AND FROM THE FOLLOWING O.D.O.T. PLANS:
WAY-302-1.29 (1989)
WAY-302-1.3 (M13, M13.813, M13.78) (1990)
WAY-302-2.3 (M13, M13.813, M13.78) (1990)
SH 641 SEC. C.D. & E-PT (1932)
DEDICATION PLAT OF SAVANNAH-WOOSTER RD (1936)
SEE COORDINATE TABLE CENTERLINE PLAT SHEETS 6 & 7.

PROJECT CONTROL
I, RAYMOND W. FOOS, P.S., HAVE CONDUCTED A SURVEY OF THE EXISTING CONDITIONS FOR THE OHIO DEPARTMENT OF TRANSPORTATION. THE RESULTS OF THAT SURVEY ARE CONTAINED HEREIN.

UNDERGROUND UTILITY LOCATIONS ARE SHOWN FOR INFORMATIONAL PURPOSES ONLY. THOUGH THEY ARE BELIEVED TO BE ACCURATE, THEIR LOCATION IS AS MARKED ON THE GROUND BY THE UTILITY COMPANY PER OUPS CONFIGURATION NUMBER AIRTR27, AIRTR08, & AIRTR03, OCPPS CONFIGURATION NUMBER 88377 AND THOSE MARKINGS SUBSEQUENTLY BEING SURVEYED AS A PART OF THIS PROJECT.

THE HORIZONTAL COORDINATES EXPRESSED HEREIN ARE BASED ON THE OHIO STATE PLANE COORDINATE SYSTEM, NORTH ZONE BY TIES TO THE ODOT VRS NETWORK. POSITIONAL TOLERANCES OF ALL CONTROL POINTS MEET THE CURRENT ODOT SURVEY AND MAPPING SPECIFICATIONS. THE UNLESS PROJECT ADJUSTMENT FACTOR USED FOR THIS PROJECT IS 1.00009047.

FURTHERMORE, I HAVE CALCULATED THE PROPOSED PROPERTY LINES, GROSS TAKE, PRESENT ROAD OCCUPIED, NET TAKE AND RESIDUE MEASUREMENTS AND THE VERTICALLY ADJUSTED DATA, AS WELL AS PREPARED THE LEGAL DESCRIPTIONS NECESSARY TO ACQUIRE THESE PARCELS AS SHOWN HEREIN.

AS PART OF THIS PROJECT I HAVE DETERMINED THE LOCATIONS OF THE EXISTING PROPERTY LINES FOR PROPERTY TAKES POINTS SHOWN HEREIN, AS CONDUCTED IN ACCORDANCE WITH OHIO ADMINISTRATIVE CODE 4733-37 COMMONLY KNOWN AS MINIMUM STANDARDS FOR BOUNDARY SURVEY IN THE STATE OF OHIO UNLESS SO NOTED.

THE MONUMENTS I AND MY AS USED HEREIN ARE TO MEAN THAT EITHER MYSELF OR SOMEONE WORKING FOR ME UNDER MY DIRECT CONTROL AND SUPERVISION.

RAYMOND W. FOOS, PROFESSIONAL LAND SURVEYOR NO. 7812

WAY-302-6.22
WAYNE COUNTY
CHESTER TOWNSHIP
SECTION 36
T. 20 N., R. 14 W.

SR 539
P.L. STA. 9+01.55
Δ = 28° 46' 00" (RT)
Dc = 5' 00' 00"
R = 1,465.92'
T = 272.64'
L = 535.33'
E = 31.99'
C.B. = N 17° 46' 01" W

SR 302
P.L. STA. 298+16.41
Δ = 22° 51' 28" (RT)
Dc = 10' 00' 00"
R = 572.96'
T = 155.83'
L = 226.58'
E = 11.59'
C.B. = N 69° 52' 03" W

SR 302
P.L. STA. 109+44.53
Δ = 36° 27' 07" (LT)
Dc = 10' 00' 00"
R = 572.96'
T = 155.83'
L = 226.58'
E = 11.59'
C.B. = N 69° 52' 03" W

SR 302
P.L. STA. 331+31.45
Δ = 34° 05' 22" (RT)
Dc = 6' 00' 00"
R = 954.93'
T = 292.77'
L = 568.16'
E = 43.87'
C.B. = N 77° 50' 45" W

SR 302
P.L. STA. 343+40.37
Δ = 13° 05' 24" (LT)
Dc = 2' 00' 00"
R = 2,546.48'
T = 292.16'
L = 581.79'
E = 16.71'
C.B. = N 67° 20' 48" W

SR 302
P.L. STA. 351+27.37
Δ = 65° 20' 19" (RT)
Dc = 2' 00' 00"
R = 2,864.79'
T = 158.63'
L = 316.93'
E = 4.39'
C.B. = N 10° 43' 19" W

SR 302
P.L. STA. 358+52.12
Δ = 3° 13' 00" (RT)
Dc = 1' 00' 00"
R = 5,129.58'
T = 160.81'
L = 321.67'
E = 2.26'
C.B. = N 65° 56' 39" W

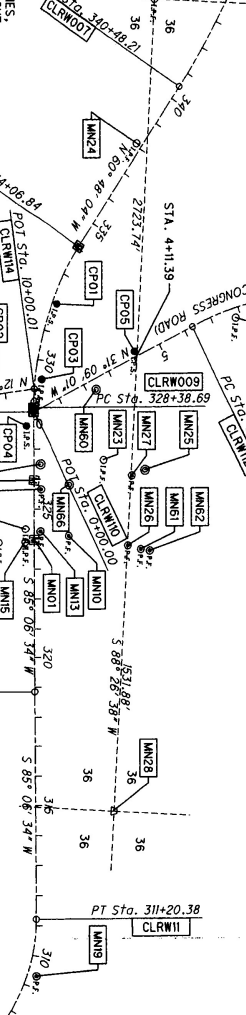

BASIS FOR BEARINGS.
THE BEARINGS REFERRED TO HEREIN ARE RELATIVE TO GRID NORTH OF THE OHIO STATE PLANE COORDINATE SYSTEM, NORTH ZONE MAD 83 (GORS 98) DATUM FROM GPS OBSERVATIONS OF THE ODOT VRS SURVEY DEPARTMENT MARCH 2013 BY ODOT DISTRICT THREE SURVEY DEPARTMENT AND ARE FOR THE PURPOSE OF DEFINING ANGULAR MEASUREMENTS.

SR 539
P.L. STA. 9+01.55
Δ = 28° 46' 00" (RT)
Dc = 5' 00' 00"
R = 1,465.92'
T = 272.64'
L = 535.33'
E = 31.99'
C.B. = N 17° 46' 01" W

SR 302
P.L. STA. 298+16.41
Δ = 22° 51' 28" (RT)
Dc = 10' 00' 00"
R = 572.96'
T = 155.83'
L = 226.58'
E = 11.59'
C.B. = N 69° 52' 03" W

SR 302
P.L. STA. 109+44.53
Δ = 36° 27' 07" (LT)
Dc = 10' 00' 00"
R = 572.96'
T = 155.83'
L = 226.58'
E = 11.59'
C.B. = N 69° 52' 03" W

SR 302
P.L. STA. 331+31.45
Δ = 34° 05' 22" (RT)
Dc = 6' 00' 00"
R = 954.93'
T = 292.77'
L = 568.16'
E = 43.87'
C.B. = N 77° 50' 45" W

SR 302
P.L. STA. 343+40.37
Δ = 13° 05' 24" (LT)
Dc = 2' 00' 00"
R = 2,546.48'
T = 292.16'
L = 581.79'
E = 16.71'
C.B. = N 67° 20' 48" W

SR 302
P.L. STA. 351+27.37
Δ = 65° 20' 19" (RT)
Dc = 2' 00' 00"
R = 2,864.79'
T = 158.63'
L = 316.93'
E = 4.39'
C.B. = N 10° 43' 19" W

SR 302
P.L. STA. 358+52.12
Δ = 3° 13' 00" (RT)
Dc = 1' 00' 00"
R = 5,129.58'
T = 160.81'
L = 321.67'
E = 2.26'
C.B. = N 65° 56' 39" W

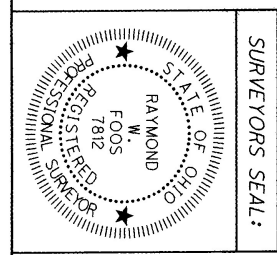

SURVEYORS SEAL:
STATE OF OHIO
RAYMOND W. FOOS
REGISTERED PROFESSIONAL SURVEYOR
NO. 7812

SETTING OF ALL MONUMENTS SHALL BE PERFORMED BY A SURVEYOR REGISTERED IN THE STATE OF OHIO. THE MONUMENT ASSEMBLIES AND REFERENCE MONUMENTS IN THIS PLAT SHALL BE INSTALLED BY THE CONTRACTOR'S SURVEYOR.

CHANGES OR ALTERATIONS TO THE LOCATION OF AN MONUMENTS SHOWN IN THIS PLAT SHALL BE APPROVED BY THE SURVEYOR REGISTERED IN THE EVENT THAT CHANGES OR ALTERATIONS ARE APPROVED. A REVISED CENTERLINE PLAT REFLECTING THE CHANGES SHALL BE SUBMITTED TO THE APPLICABLE COUNTY RECORDING AGENCIES FOR RECORDATION. MONUMENTS AND RIGHT OF WAY MONUMENTS ARE SHOWN ON STANDARD CONSTRUCTION DRAWING RM-11.

RECEIVED 4-17-26
BOOK 54 PAGE 415
COUNTY RECORDER

