

BOUNDARY DESCRIPTION  
0.054 Acres

Situated in the State of Ohio, County of Wayne, **Township of Paint** in the **northwest quarter of Section 17, T-15N, R-11W.**

Being part of the land described in deeds to **Esther Raber** recorded in official record volume 317, page 999 and official record volume 851, page 612 of the Wayne County records.

Described as follows:

**Commencing** at a railroad spike found in Kidron Road (County Road 52) marking the northwest corner of Section 17 – witnessed by a 5/8 inch diameter steel reference pin found N 88° 46' 29" E 30.00 feet.

Thence N 88° 46' 29" E 455.30 feet, along the north line of the quarter section, to a 5/8 inch diameter steel pin found at the **Point of Beginning** for the parcel herein described.

Thence with the following FOUR courses:

- 1) **N 88° 46' 29" E 229.77 feet**, along the north line of the quarter section, to the southeast corner of a 4.093 acre parcel described in a deed to John E. and Ada Weaver recorded in official record volume 943, page 3155 – witnessed by a capped pin marked "Diversified Engineering" found N 00° 52' 46" W 0.54 feet.
- 2) **S 00° 52' 46" E 6.22 feet** to a point in a tree – witnessed by a capped reference pin set S 86° 44' 57" W 9.91 feet.
- 3) **S 86° 44' 57" W 229.98 feet** to a point on an easterly line of said Weaver – witnessed by a capped reference pin set N 86° 44' 57" E 5.00 feet.
- 4) **N 00° 48' 50" W 14.35 feet**, along the easterly line of Weaver, to the **Point of Beginning**.

**This parcel contains 0.054 acres** and has no frontage on any public way.

Prior Instrument: official record volume 317, page 999 and official record volume 851, page 612.

Permanent Parcel #: part of 39-00791.005

This description was prepared by Edward A. Gasbarre, P.S. 7036, from information contained in a survey made under his direction, in November of 2022, on behalf of R.W. Gasbarre & Associates, Inc.

A copy of that survey is on file at the Wayne County map office. See survey volume XX page 409

All bearings are related and based on grid North of the Ohio State Plane Coordinate System.

All capped pins, both set and found, are 5/8 inch diameter solid steel rods with identification caps marked "GASBARRE WOOSTER, OHIO" unless otherwise noted.

  
Edward A. Gasbarre, P.S. 7036

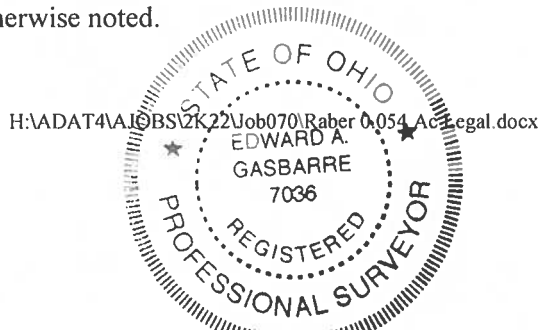

**BOUNDARY DESCRIPTION**  
**4.151 Acres**

Situated in the State of Ohio, County of Wayne, **Township of Paint** in the **southwest quarter of Section 8** and the **northwest quarter of Section 17, T-15N, R-11W.**

Being part of the land described in a deed to **John E. and Ada Weaver** recorded in official record volume 943, page 3155 and all of the land described in official record volume \_\_\_\_, page \_\_\_\_ of the Wayne County records.

Described as follows:

**Beginning** at a railroad spike found in Kidron Road (County Road 52) marking the southwest corner of Section 8 – witnessed by a 5/8 inch diameter steel reference pin found N 88° 46' 29" E 30.00 feet.

Thence with the following TWELVE courses:

- 1) **N 00° 52' 19" W 174.93 feet**, along the west line of the quarter section, to the southwest corner of Marty and Mary Ann Yoder as described in official record volume 903, page 4693 – witnessed by a 5/8 inch diameter steel reference pin found N 88° 44' 20" E 30.00 feet.
- 2) **N 88° 44' 20" E 323.82 feet**, along a southerly line of Yoder, to a point in a building – witnessed by capped reference pins found S 88° 44' 20" W 5.00 feet and N 00° 39' 59" W 16.00 feet.
- 3) **N 00° 39' 59" W 42.69 feet**, along an easterly line of Yoder, to a capped pin found.
- 4) **N 88° 44' 40" E 133.23 feet**, along a southerly line of Yoder, to a capped pin found.
- 5) **N 00° 48' 49" W 123.36 feet**, along an easterly line of Yoder, to a 5/8 inch diameter steel pin found.
- 6) **N 88° 45' 50" E 227.70 feet**, along a southerly line of David E. and Linda Hershberger as described in official record volume 413, page 677, to a one inch diameter crimped steel pipe found.
- 7) **S 00° 52' 46" E 347.52 feet**, along the west line of a 5.780 acre parcel described in a deed to John E. and Ada Weaver recorded in official record volume 943, page 3155, the extension thereof and passing into the northwest quarter of Section 17 at a distance of 341.30 feet, to a point in a tree – witnessed by a capped pin marked "Diversified Engineering" found N 00° 52' 46" W 0.54 feet and a capped reference pin set S 86° 44' 57" W 9.91 feet.
- 8) **S 86° 44' 57" W 229.98 feet** to a point on a westerly line of Esther Raber as described in official record volume 317, page 999 and official record volume 851, page 612 – witnessed by a capped reference pin set N 86° 44' 57" E 5.00 feet.
- 9) **S 00° 48' 50" E 69.65 feet**, along the westerly line of Raber, to a capped pin marked "Purdy" found at a northeasterly corner of a 4.093 acre parcel described in a deed to John E. and Ada Weaver recorded in official record volume 934, page 3155.

- 10) S 88° 46' 29" W 178.00 feet, along a southerly line of Weaver, to a capped pin marked "Purdy" found.
- 11) N 00° 48' 50" W 84.00 feet, along a westerly line of Weaver, to a capped pin marked "Purdy" found on the north line of the quarter section.
- 12) S 88° 46' 29" W 277.30 feet, along the north line of the quarter section, to the **Point of Beginning**.

**This parcel contains 4.151 acres;** of which 3.754 acres lie in the southwest quarter of Section 8 and 0.397 acres lie in the northwest quarter of Section 17.

Prior Instrument: official record volume 943, page 3155 and official record volume \_\_\_\_, page \_\_\_\_.

Permanent Parcel #: all of 39-00122.000

This description was prepared by Edward A. Gasbarre, P.S. 7036, from information contained in a survey made under his direction, in November of 2022, on behalf of R. W. Gasbarre & Associates, Inc. A copy of that survey is on file at the Wayne County map office. See survey volume XX page 409

All bearings are related and based on Grid North of the Ohio State Plane Coordinate System.

All capped pins, both set and found, are 5/8 inch diameter solid steel rods with identification caps marked "GASBARRE WOOSTER, OHIO" unless otherwise noted.

 11/08/22

Edward A. Gasbarre, P.S. 7036

H:\ADAT4\AJOB52K22\Job070\Weaver 4.151 Ac Legal.docx

