

Baker Surveying, LLC
138 N Clay St.
Millersburg, OH 44654

Telephone: 330-674-4788
Email: bakersurveying@gmail.com

Description 57.025 acre parcel

Situated in the Township of Salt Creek (T-15 N, R-12 W), northeast quarter of Section 21, County of Wayne and State of Ohio.

Described as follows:

Beginning at a 5/8 inch rebar found in Salt Creek Road aka C.R. 109 marking the southwest corner of the northeast quarter of Section 21 the TRUE POINT OF BEGINNING, witnessed by a mag nail found N 01 degrees 40' 48" W 30.00 feet.

thence with the following TWENTY-SIX (26) COURSES:

- 1) N 01 degrees 40' 48" W 1460.94 feet along the quarter section line to a 5/8 inch rebar found;
- 2) N 73 degrees 42' 15" E 168.44 feet along Neal Yoder's (O.R. 948 page 5459) south line to a 5/8 inch rebar found;
- 3) N 08 degrees 48' 40" W 148.08 feet along said Yoder's east line to a 5/8 inch rebar found;
- 4) N 32 degrees 23' 23" E 166.81 feet along said Yoder's east line to a 5/8 inch rebar found;
- 5) N 20 degrees 49' 46" W 79.11 feet along said Yoder's east line to a 5/8 inch rebar found;
- 6) N 21 degrees 24' 58" E 45.70 feet along said Yoder's east line to a 5/8 inch rebar found;
- 7) N 03 degrees 36' 21" W 332.56 feet along said Yoder's east line to a 5/8 inch rod found;
- 8) N 00 degrees 01' 20" W 381.75 feet along said Yoder's east line to a 5/8 inch rod found;
- 9) N 02 degrees 08' 37" W 35.03 feet along said east line to a R.R. spike found on the section line and in Frease Road aka T.R. 340;
- 10) N 87 degrees 52' 51" E 805.01 feet along the section line and along Frease Road aka T.R. 340 to a R.R. spike found;

- 11) S 02 degrees 07' 09" E 30.00 feet through the lands of Albert J. Miller and Mary L. Miller (O.R. 948 page 5481) to a 5/8 inch rebar found;
- 12) S 61 degrees 47' 45" E 163.00 feet through the lands of said Miller to a 5/8 inch rebar found;
- 13) S 02 degrees 07' 09" W 260.00 feet through the lands of said Miller to an iron pin set;
- 14) S 09 degrees 52' 45" E 287.58 feet through the lands of said Miller to an iron pin set;
- 15) N 88 degrees 25' 02" E 150.00 feet through the lands of said Miller to an iron pin set;
- 16) S 01 degrees 34' 58" E 860.43 feet along said Miller's (PN 45-00744.005) west line to a 5/8 inch rebar found;
- 17) S 00 degrees 35' 31" E 362.27 feet along Michael J. Miller and Luanne O. Miller's (O.R. 874 page 619) west line to a 5/8 inch rebar found;
- 18) N 89 degrees 32' 22" W 707.13 feet partly along Ella D. Yoder and Erma D. Yoder, Co-Trustees' (O.R. 943 page 1258) north line and partly through the lands of said Albert J. Miller and Mary L. Miller to an iron pin set;
- 19) S 01 degrees 40' 48" E 205.20 feet through the lands of said Albert J. Miller and Mary L. Miller to a 5/8 inch rebar found;
- 20) N 88 degrees 50' 53" W 307.81 feet along Andy L. Yoder's (O.R. 948 page 5469) north line to a 5/8 inch rebar found;
- 21) S 01 degrees 40' 48" E 71.41 feet along said Andy L. Yoder's west line to an iron pin set;
- 22) S 88 degrees 50' 53" W 147.59 feet through the lands of said Albert J. Miller and Mary L. Miller to an iron pin set;
- 23) S 01 degrees 40' 48" E 147.59 feet through the lands of said Albert J. Miller and Mary L. Miller to an iron pin set;
- 24) N 88 degrees 50' 53" E 147.59 feet through the lands of said Albert J. Miller and Mary L. Miller to an iron pin set;
- 25) S 01 degrees 40' 48" E 390.00 feet along said Andy L. Yoder's west line to a point on the quarter section line and in Salt Creek Road aka C.R. 109, witnessed by a 5/8 inch rebar found N 01 degrees 40' 48" W 28.34 feet;
- 26) S 88 degrees 50' 53" W 346.40 feet along the quarter section line and along Salt Creek Road aka C.R. 109 to the TRUE POINT OF BEGINNING.

This parcel contains 57.025 acres, but subject to all highways and easements of record.

This parcel is granted the use of an existing 30 foot easement recorded in Official Record vol. 948 page 5481.

This parcel is subject to an existing 30 foot easement recorded in Official Record vol. 948 page 5481.

This parcel is also subject to a 30 foot easement for the purpose of ingress and egress, further described as follows:

Situated in the Township of Salt Creek (T-15 N, R-12 W), northeast quarter of Section 21, County of Wayne and State of Ohio.

Commencing at a 5/8 inch rebar found in Salt Creek Road aka C.R. 109 marking the southwest corner of the northeast quarter of Section 21, thence N 88 degrees 50' 53" E 331.40 feet along the quarter section line and along Salt Creek Road aka C.R. 109 to a point the TRUE POINT OF BEGINNING.

thence N 01 degrees 40' 48" W 390.00 feet through the lands of Albert J. Miller and Mary L. Miller (O.R. 948 page 5481) to the south line of a 0.500 acre parcel and THERE ENDS.

All iron pins set are 5\8 inch rebars with a plastic identification cap marked "Baker Surveying LLC".
Basis of bearings from Ohio State Plane Coordinate System, North Zone, N.A.D. 83, 2011 Adjustment.

This description prepared by Aaron L. Gerber, P.S. 8379, January 19, 2023.
For survey, See Volume XX, Page 442 of the Wayne County Survey Records.



Aaron L. Gerber P.S. 8379



Baker Surveying, LLC
138 N Clay St.
Millersburg, OH 44654

Telephone: 330-674-4788
Email: bakersurveying@gmail.com

Description 5.732 acre parcel

Situated in the Township of Salt Creek (T-15 N, R-12 W), northeast quarter of Section 21, County of Wayne and State of Ohio.

Described as follows:

Commencing at a 5/8 inch rebar found in Salt Creek Road aka C.R. 109 marking the southwest corner of the northeast quarter of Section 21, thence N 88 degrees 50' 53" E 809.20 feet along the quarter section line and along Salt Creek Road aka C.R. 109 to a point the TRUE POINT OF BEGINNING, witnessed by a 5/8 inch rebar found N 01 degrees 40' 48" W 30.00 feet.

thence with the following SIX (6) COURSES:

- 1) N 01 degrees 40' 48" W 609.00 feet along Andy L. Yoder's (O.R. 948 page 5469) east line to a 5/8 inch rebar found;
- 2) S 88 degrees 50' 53" W 154.99 feet along said Yoder's north line to a 5/8 inch rebar found;
- 3) N 01 degrees 40' 48" W 205.20 feet through the lands of Albert J. Miller and Mary L. Miller (O.R. 948 page 5481) to an iron pin set;
- 4) S 89 degrees 32' 22" E 426.04 feet through the lands of said Miller to a 5/8 inch rebar found;
- 5) S 01 degrees 40' 48" E 802.21 feet along Ella D. Yoder and Erma D. Yoder, Co-Trustees' (O.R. 943 page 1258) west line to a point on the quarter section line and in Salt Creek Road aka C.R. 109, witnessed by a 5/8 inch rebar found N 01 degrees 40' 48" W 30.00 feet;
- 6) S 88 degrees 50' 53" W 270.77 feet along the quarter section line and along Salt Creek Road aka C.R. 109 to the TRUE POINT OF BEGINNING.

This parcel contains 5.732 acres, but subject to all highways and easements of record.

All iron pins set are 5/8 inch rebars with a plastic identification cap marked "Baker Surveying LLC".
Basis of bearings from Ohio State Plane Coordinate System, North Zone, N.A.D. 83, 2011 Adjustment.

This description prepared by Aaron L. Gerber, P.S. 8379, January 20, 2023.
For survey, See Volume XX, Page 442 of the Wayne County Survey Records.

AL

Aaron L. Gerber P.S. 8379

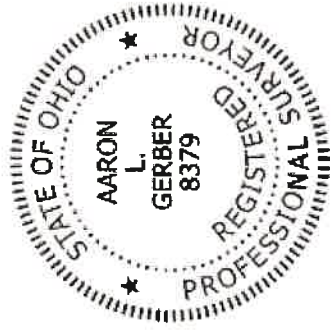

Baker Surveying, LLC
138 N Clay St.
Millersburg, OH 44654

Telephone: 330-674-4788
Email: bakersurveying@gmail.com

Description 0.500 acre parcel

Situated in the Township of Salt Creek (T-15 N, R-12 W), northeast quarter of Section 21, County of Wayne and State of Ohio.

Described as follows:

Commencing at a 5/8 inch rebar found in Salt Creek Road aka C.R. 109 marking the southwest corner of the northeast quarter of Section 21, thence N 88 degrees 50' 53" E 346.40 feet along the quarter section line and along Salt Creek Road aka C.R. 109 to a point, thence N 01 degrees 40' 48" W 390.00 feet along Andy L. Yoder's (O.R. 948 page 5469) west line to an iron pin set the TRUE POINT OF BEGINNING.

thence with the following FOUR (4) COURSES:

- 1) S 88 degrees 50' 53" W 147.59 feet through the lands of Albert J. Miller and Mary L. Miller (O.R. 948 page 5481) to an iron pin set;
- 2) N 01 degrees 40' 48" W 147.59 feet through the lands of said Miller to an iron pin set;
- 3) N 88 degrees 50' 53" E 147.59 feet through the lands of said Miller to an iron pin set on said Yoder's west line;
- 4) S 01 degrees 40' 48" E 147.59 feet along said Yoder's west line to the TRUE POINT OF BEGINNING.

This parcel contains 0.500 acres, but subject to all highways and easements of record.

The above described 0.500 acre parcel is for cemetery use only and is not to be used as a building lot.

This parcel has access by a 30 foot easement for the purpose of ingress and egress, further described as follows:

Situated in the Township of Salt Creek (T-15 N, R-12 W), northeast quarter of Section 21, County of Wayne and State of Ohio.

Commencing at a 5/8 inch rebar found in Salt Creek Road aka C.R. 109 marking the southwest corner of the northeast quarter of Section 21, thence N 88 degrees 50' 53" E 331.40 feet along the quarter section line and along Salt Creek Road aka C.R. 109 to a point the TRUE POINT OF BEGINNING.

thence N 01 degrees 40' 48" W 390.00 feet through the lands of Albert J. Miller and Mary L. Miller (O.R. 948 page 5481) to the south line the above described 0.500 acre parcel and THERE ENDS.

All iron pins set are 5/8 inch rebars with a plastic identification cap marked "Baker Surveying LLC".
Basis of bearings from Ohio State Plane Coordinate System, North Zone, N.A.D. 83, 2011 Adjustment.

This description prepared by Aaron L. Gerber, P.S. 8379, January 19, 2023.
For survey, See Volume XX, Page 442 of the Wayne County Survey Records.

AL

Aaron L. Gerber P.S. 8379

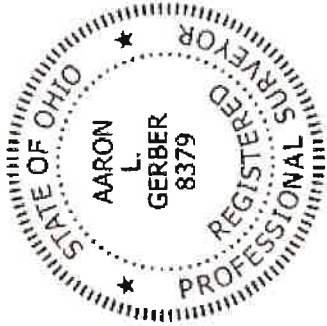

Baker Surveying, LLC
138 N Clay St.
Millersburg, OH 44654

Telephone: 330-674-4788
Email: bakersurveying@gmail.com

Description 11.038 acre parcel

Situated in the Township of Salt Creek (T-15 N, R-12 W), northeast quarter of Section 21, County of Wayne and State of Ohio.

Described as follows:

Commencing at a 5/8 inch rebar found in Salt Creek Road aka C.R. 109 marking the southwest corner of the northeast quarter of Section 21, thence N 88 degrees 50' 53" E 809.20 feet along the quarter section line and along Salt Creek Road aka C.R. 109 to a point, thence N 01 degrees 40' 48" W 609.00 feet along Andy L. Yoder's (O.R. 948 page 5469) east line to a 5/8 inch rebar found, thence S 88 degrees 50' 53" W 154.99 feet along said Yoder's north line to a 5/8 inch rebar found, thence N 01 degrees 40' 48" W 205.20 feet along Albert J. Miller and Mary L. Miller's (O.R. 948 page 5481, PN 45-00505.000) east line to an iron pin set the TRUE POINT OF BEGINNING.

thence with the following SEVEN (7) COURSES:

- 1) N 01 degrees 40' 48" W 261.17 feet along said Miller's east line to a point;
- 2) N 32 degrees 36' 30" E 285.62 feet along said Miller's east line to a point;
- 3) N 43 degrees 09' 22" E 525.36 feet along said Miller's east line to a point;
- 4) N 89 degrees 24' 29" E 183.12 feet along said Miller's south line to a point;
- 5) S 01 degrees 34' 58" E 530.44 feet along said Miller's (PN 45-00744.005) west line to a 5/8 inch rebar found;
- 6) S 00 degrees 35' 31" E 362.27 feet along Michael J. Miller and Luanne O. Miller's (O.R. 874 page 619) west line to a 5/8 inch rebar found;
- 7) N 89 degrees 32' 22" W 707.13 feet partly along Ella D. Yoder and Erma D. Yoder, Co-Trustees' (O.R. 943 page 1258) north line and partly through the lands of said Albert J. Miller and Mary L. Miller's (PN 45-00505.009) to the TRUE POINT OF BEGINNING.

This parcel contains 11.038 acres, but subject to all highways and easements of record.

This parcel is being created pursuant to Ohio Revised Code Section 711.001, wherein it is a transfer between adjoining land owners and does not create an additional building

site. It is not to be used as a separate building site or transferred as an independent parcel in the future.

All iron pins set are 5/8 inch rebar with a plastic identification cap marked "Baker Surveying LLC".
Basis of bearings from Ohio State Plane Coordinate System, North Zone, N.A.D. 83, 2011 Adjustment.

This description prepared by Aaron L. Gerber, P.S. 8379, January 19, 2023.
For survey, See Volume XX, Page 442 of the Wayne County Survey Records.

ALC

Aaron L. Gerber P.S. 8379

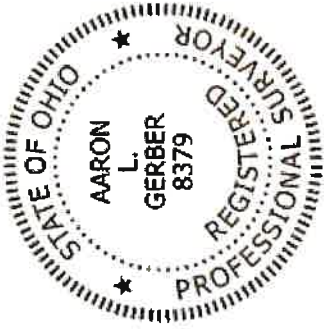

Baker Surveying, LLC

138 N Clay St.
Millersburg, OH 44654

Telephone: 330-674-4788
Email: bakersurveying@gmail.com

Description 3.000 acre parcel

Situated in the Township of Salt Creek (T-15 N, R-12 W), northeast quarter of Section 21, County of Wayne and State of Ohio.

Described as follows:

Commencing at a 1 inch rod found in Frease Road aka T.R. 340 marking the northwest corner of the northeast quarter of Section 21, thence N 87 degrees 52' 51" E 1034.63 feet along the section line and along Frease Road aka T.R. 340 to a R.R. spike found the TRUE POINT OF BEGINNING.

thence with the following EIGHT (8) COURSES:

- 1) N 87 degrees 52' 51" E 335.52 feet along the section line and along Frease Road aka T.R. 340 to a point, witnessed by a 3/4 inch rebar found S 01 degrees 36' 34" E 29.73 feet;
- 2) S 01 degrees 36' 34" E 362.82 feet along Daniel J. Miller and Elsie L. Miller's (O.R. 922 page 2455) west line to a 3/4 inch rebar found;
- 3) S 01 degrees 34' 58" E 295.85 feet along Albert J. Miller and Mary L. Miller's (O.R. 948 page 5481, PN 45-00744.005) west line to an iron pin set;
- 4) S 88 degrees 25' 02" W 150.00 feet through the lands of said Miller (PN 45-00505.000) to an iron pin set;
- 5) N 09 degrees 52' 45" W 287.58 feet through the lands of said Miller to an iron pin set;
- 6) N 02 degrees 07' 09" W 260.00 feet through the lands of said Miller to a 5/8 inch rebar found;
- 7) N 61 degrees 47' 45" W 163.00 feet through the lands of said Miller to a 5/8 inch rebar found;
- 8) N 02 degrees 07' 09" W 30.00 feet through the lands of said Miller to the TRUE POINT OF BEGINNING.

This parcel contains 3.000 acres, but subject to all highways and easements of record.

All iron pins set are 5/8 inch rebars with a plastic identification cap marked "Baker Surveying LLC".
Basis of bearings from Ohio State Plane Coordinate System, North Zone, N.A.D. 83, 2011 Adjustment.

This description prepared by Aaron L. Gerber, P.S. 8379, January 20, 2023.
For survey, See Volume XX, Page 442 of the Wayne County Survey Records.

ALG

Aaron L. Gerber P.S. 8379

