

Baker Surveying, LLC

138 N Clay St.
Millersburg, OH 44654

Telephone: 330-674-4788
Email: bakersurveying@gmail.com

Description 16.216 acre parcel

Situated in the Township of Paint (T-15 N, R-11 W), southwest quarter of Section 15, County of Wayne and State of Ohio.

Described as follows:

Commencing at a stone found marking the southwest corner of the southwest quarter of Section 15, thence N 89 degrees 43' 15" E 434.81 feet along the section line to a point in Winesburg Road aka C.R. 37, thence N 02 degrees 24' 27" E 20.02 feet along the centerline of Winesburg Road aka C.R. 37 to a point, thence N 00 degrees 46' 10" W 191.79 feet along the centerline of Winesburg Road aka C.R. 37 to a point, thence N 00 degrees 11' 59" E 516.09 feet along the centerline of Winesburg Road aka C.R. 37 to a point, thence N 00 degrees 29' 21" W 300.00 feet along the centerline of Winesburg Road aka C.R. 37 to a R.R. spike found the TRUE POINT OF BEGINNING, witnessed by an iron pin set S 88 degrees 20' 38" E 35.53 feet.

thence with the following EIGHT (8) COURSES:

- 1) N 00 degrees 44' 48" W 368.42 feet along the centerline of Winesburg Road aka C.R. 37 to a point;
- 2) N 00 degrees 47' 34" W 470.33 feet along the centerline of Winesburg Road aka C.R. 37 to a point, witnessed by a mag nail set N 75 degrees 17' 17" E 32.31 feet;
- 3) N 75 degrees 17' 17" E 345.73 feet to an iron pin set;
- 4) S 56 degrees 00' 40" E 233.00 feet to an iron pin set;
- 5) S 34 degrees 39' 06" E 93.91 feet to an iron pin set;
- 6) N 75 degrees 17' 17" E 152.18 feet to an iron pin set on Eli L. Hershberger and Ada D. Hershberger's (O.R. 900 page 23) west line;
- 7) S 16 degrees 56' 35" E 820.89 feet along said Hershberger's west line to a point in a pond, witnessed by an iron pin set N 16 degrees 56' 35" W 303.89 feet;
- 8) N 88 degrees 20' 38" W 956.49 feet along Summit Investment Holdings, LLC's (O.R. 491 page 1866) north line to the TRUE POINT OF BEGINNING.

This parcel contains 16.216 acres, but subject to all highways and easements of record.

All iron pins set are 5/8 inch rebar with a plastic identification cap marked "Baker Surveying LLC".
Basis of bearings from Ohio State Plane Coordinate System, North Zone, N.A.D. 83, 2011 Adjustment.

This description prepared by Aaron L. Gerber, P.S. 8379, January 31, 2023.
For survey, See Volume XX, Page 463 of the Wayne County Survey Records.

AL

Aaron L. Gerber P.S. 8379

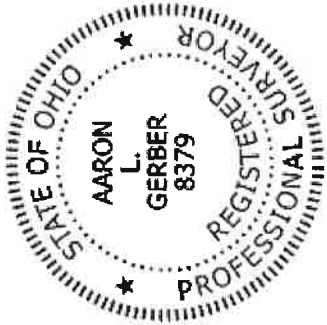

Baker Surveying, LLC

138 N Clay St.
Millersburg, OH 44654

Telephone: 330-674-4788
Email: bakersurveying@gmail.com

Description 1.820 acre parcel

Situated in the Township of Paint (T-15 N, R-11 W), southwest quarter of Section 15, County of Wayne and State of Ohio.

Described as follows:

Commencing at a stone found marking the southwest corner of the southwest quarter of Section 15, thence N 89 degrees 43' 15" E 434.81 feet along the section line to a point in Winesburg Road aka C.R. 37, thence N 02 degrees 24' 27" E 20.02 feet along the centerline of Winesburg Road aka C.R. 37 to a point, thence N 00 degrees 46' 10" W 191.79 feet along the centerline of Winesburg Road aka C.R. 37 to a point, thence N 00 degrees 11' 59" E 516.09 feet along the centerline of Winesburg Road aka C.R. 37 to a point, thence N 00 degrees 29' 21" W 300.00 feet along the centerline of Winesburg Road aka C.R. 37 to a R.R. spike found, thence N 00 degrees 44' 48" W 368.42 feet along the centerline of Winesburg Road aka C.R. 37 to a point, thence N 00 degrees 47' 34" W 470.33 feet along the centerline of Winesburg Road aka C.R. 37 to a point the TRUE POINT OF BEGINNING, witnessed by a mag nail set N 75 degrees 17' 17" E 32.31 feet.

thence with the following SEVEN (7) COURSES:

- 1) N 00 degrees 47' 34" W 30.91 feet along the centerline of Winesburg Road aka C.R. 37 to a R.R. spike found, witnessed by a 5/8 inch rebar found N 75 degrees 17' 17" E 29.93 feet;
- 2) N 75 degrees 17' 17" E 664.85 feet along Melissa A. Irwin and James C. Lottes' (O.R. 150 page 483) south line to a 1 inch pipe found on Eli L. Hershberger and Ada D. Hershberger's (O.R. 900 page 23) west line;
- 3) S 16 degrees 56' 35" E 293.55 feet along said Hershberger's west line to an iron pin set;
- 4) S 75 degrees 17' 17" W 152.18 feet to an iron pin set;
- 5) N 34 degrees 39' 06" W 93.91 feet to an iron pin set;
- 6) N 56 degrees 00' 40" W 233.00 feet to an iron pin set;
- 7) S 75 degrees 17' 17" W 345.73 feet to the TRUE POINT OF BEGINNING.

This parcel contains 1.820 acres, but subject to all highways and easements of record.

All iron pins set are 5/8 inch rebar with a plastic identification cap marked "Baker Surveying LLC".
Basis of bearings from Ohio State Plane Coordinate System, North Zone, N.A.D. 83, 2011 Adjustment.

This description prepared by Aaron L. Gerber, P.S. 8379, January 31, 2023.
For survey, See Volume XX, Page 463 of the Wayne County Survey Records.

AL

Aaron L. Gerber P.S. 8379

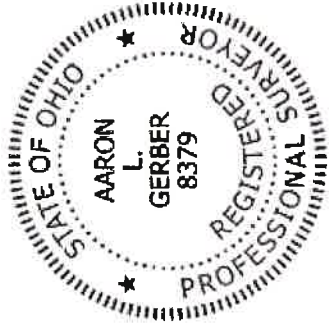

Baker Surveying, LLC

138 N Clay St.
Millersburg, OH 44654

Telephone: 330-674-4788
Email: bakersurveying@gmail.com

Description 4.262 acre parcel

Situated in the Township of Paint (T-15 N, R-11 W), southwest quarter of Section 15, County of Wayne and State of Ohio.

Described as follows:

Commencing at a stone found marking the southwest corner of the southwest quarter of Section 15, thence N 89 degrees 43' 15" E 434.81 feet along the section line to a point in Winesburg Road aka C.R. 37, thence N 02 degrees 24' 27" E 20.02 feet along the centerline of Winesburg Road aka C.R. 37 to a point, thence N 00 degrees 46' 10" W 191.79 feet along the centerline of Winesburg Road aka C.R. 37 to a point, thence N 00 degrees 11' 59" E 516.09 feet along the centerline of Winesburg Road aka C.R. 37 to a point, thence N 00 degrees 29' 21" W 300.00 feet along the centerline of Winesburg Road aka C.R. 37 to a R.R. spike found, thence S 88 degrees 20' 38" E 956.49 feet along Summit Investment Holdings LLC's (O.R. 491 page 1866) north line to a point in a pond the TRUE POINT OF BEGINNING, witnessed by an iron pin set N 88 degrees 20' 38" W 117.01 feet, also witnessed by an iron pin set N 16 degrees 56' 35" W 303.89 feet.

thence with the following SIX (6) COURSES:

- 1) N 39 degrees 13' 31" W 1190.94 feet along Innovative Realty LLC's (O.R. 805 page 1997) east line to an iron pin set;
- 2) N 75 degrees 17' 17" E 124.19 feet through the lands of Mount Eaton Care Center (O.R. 601 page 748) to an iron pin set;
- 3) S 56 degrees 00' 40" E 233.00 feet through the lands of said Mount Eaton Care Center to an iron pin set;
- 4) S 34 degrees 39' 06" E 93.91 feet through the lands of said Mount Eaton Care Center to an iron pin set;
- 5) N 75 degrees 17' 17" E 152.18 feet through the lands of said Mount Eaton Care Center to an iron pin set on Eli L. Hershberger and Ada D. Hershberger's (O.R. 900 page 23) west line;
- 6) S 16 degrees 56' 35" E 820.89 feet along said Hershberger's west line to the TRUE POINT OF BEGINNING.

This parcel contains 4.262 acres, but subject to all highways and easements of record. To go to adjainer.

The 4.262 acre parcel is being created pursuant to Ohio Revised Code Section 711.001, wherein it is a transfer between adjoining land owners and does not create an additional building site. It is not to be used as a separate building site or transferred as an independent parcel in the future.

All iron pins set are 5/8 inch rebars with a plastic identification cap marked "Baker Surveying LLC".
Basis of bearings from Ohio State Plane Coordinate System, North Zone, N.A.D. 83, 2011 Adjustment.

This description prepared by Aaron L. Gerber, P.S. 8379, January 31, 2023.
For survey, See Volume XX, Page 463 of the Wayne County Survey Records.

AL

Aaron L. Gerber P.S. 8379

